

## Electronic Trip Unit

Disparador por sobrecorriente electrónico

Déclencheur électronique

	U.S. Cat. No.	Euro Order No.
Item:	CJT_N ___	3VL94__-6GB_8
	CJT_P ___	3VL94__-6GE_8
	CJT_U ___	3VL94__-6GH_8
	CJT_X ___	3VL94__-6GD_8
	CLT_N ___	3VL94__-6GB_8
	CLT_P ___	3VL94__-6GE_8
	CLT_U ___	3VL94__-6GH_8
	CLT_X ___	3VL94__-6GD_8

For Use With Frame JG, LG

Para Usar Con Caja Base JG, LG

Installation Instructions / Instructivo de Instalación

	 <b>Danger</b>	 <b>Peligro</b>	 <b>Danger!</b>
	<b>Hazardous Voltage</b> Will cause death or serious injury Turn off and lock out all power supplying this device before working on this device. Replace all covers before power supplying this device is turned on.	<b>Tensión peligrosa.</b> Puede causar la muerte o lesiones graves. Desenergice totalmente antes de instalar o darle servicio. Reemplace todas las barreras y cubiertas antes de energizar el interruptor.	<b>Tension dangereuse.</b> Danger de mort ou risque de blessures graves. Couper l'alimentation de l'appareil et barrer avant de travailler. Remplacez tous les couverts avant que l'alimentation de pouvoir soit alimenté.

Use only with Siemens certified Components.  
 Utilizar únicamente con componentes certificados de Siemens.  
 A utiliser uniquement avec les composants certifiés Siemens.

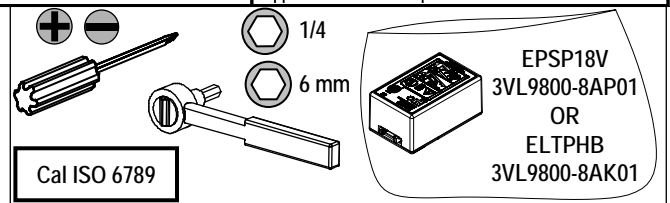

NOTE - These instructions do not purport to cover all details or variations in equipment, or to provide for every possible contingency to be met in connection with installation, operation or maintenance. Should further information be desired or should particular problems arise, which are not covered sufficiently for the purchaser's purposes, the matter should be referred to the local Siemens sales office. The contents of this instruction manual shall not become part of or modify any prior or existing agreement, commitment or relationship. The sales contract contains the entire obligation of Siemens. The warranty contained in the contract between the parties is the sole warranty of Siemens. Any statements contained herein do not create new warranties or modify the existing warranty.

Trademarks - Unless otherwise noted, all names identified by ® are registered trademarks of Siemens AG or Siemens Industry, Inc. The remaining trademarks in this publication may be trademarks whose use by third parties for their own purposes could violate the rights of the owner.

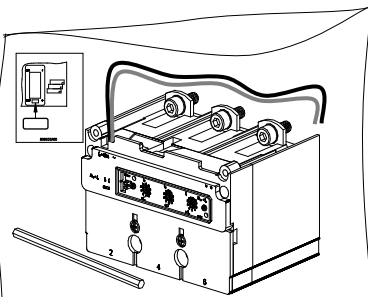
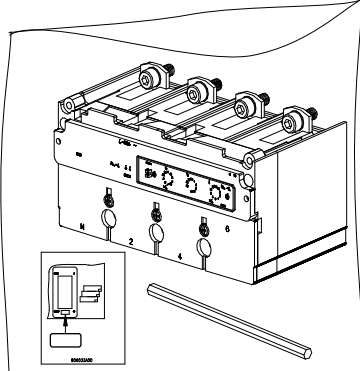
	CJT3U250	3VL9425-6GH38		CJT4N250	3VL9425-6GB48
	CJT3U400	3VL9440-6GH38		CJT4N400	3VL9440-6GB48
	CJT3X250	3VL9425-6GD38		CJT4P250	3VL9425-6GE48
	CJT3X400	3VL9440-6GD38		CJT4P400	3VL9440-6GE48
	CLT3U400	3VL9494-6GH38		CLT4N400	3VL9494-6GB48
	CLT3U600	3VL9460-6GH38		CLT4N600	3VL9460-6GB48
	CLT3X400	3VL9494-6GD38		CLT4P400	3VL9494-6GE48
	CLT3X600	3VL9460-6GD38		CLT4P600	3VL9460-6GE48

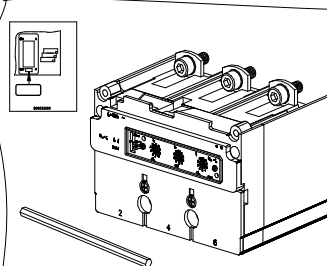
	CJT3N250	3VL9425-6GB38
	CJT3N400	3VL9440-6GB38
	CJT3P250	3VL9425-6GE38
	CJT3P400	3VL9440-6GE38
	CLT3N400	3VL9494-6GB38
	CLT3N600	3VL9460-6GB38
	CLT3P400	3VL9494-6GE38
	CLT3P600	3VL9460-6GE38

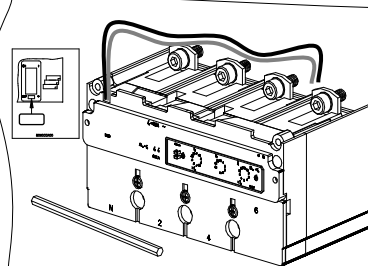
	CJT4U250	3VL9425-6GH48
	CJT4U400	3VL9440-6GH48
	CJT4X250	3VL9425-6GD48
	CJT4X400	3VL9440-6GD48
	CLT4U400	3VL9494-6GH48
	CLT4U600	3VL9460-6GH48
	CLT4X400	3VL9494-6GD48
	CLT4X600	3VL9460-6GD48

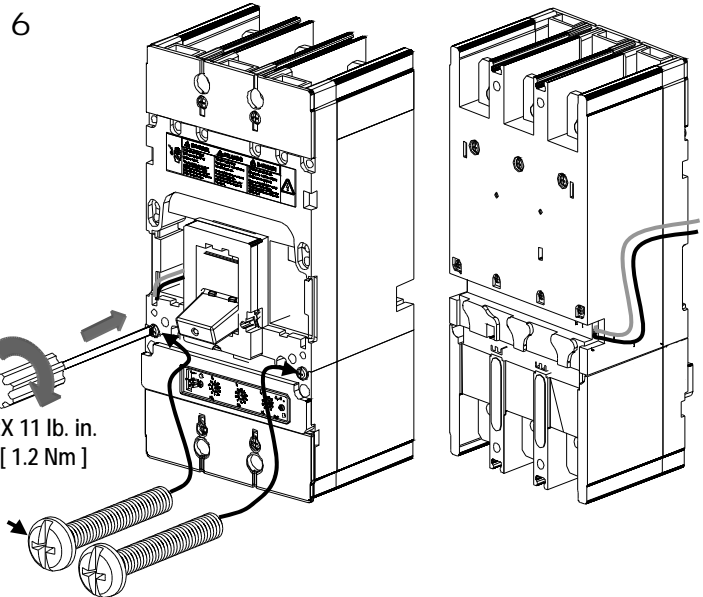
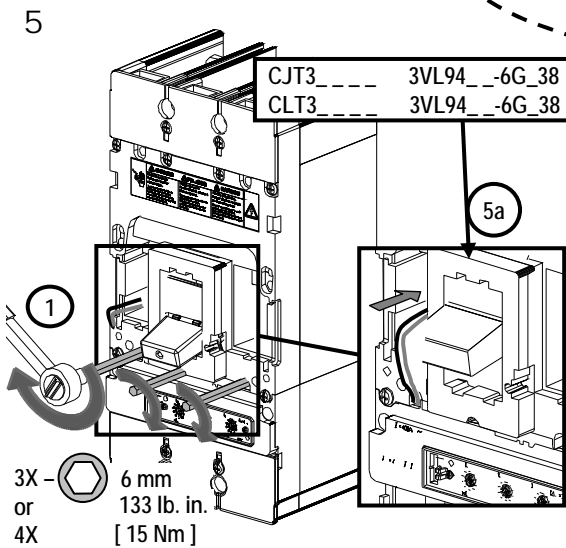
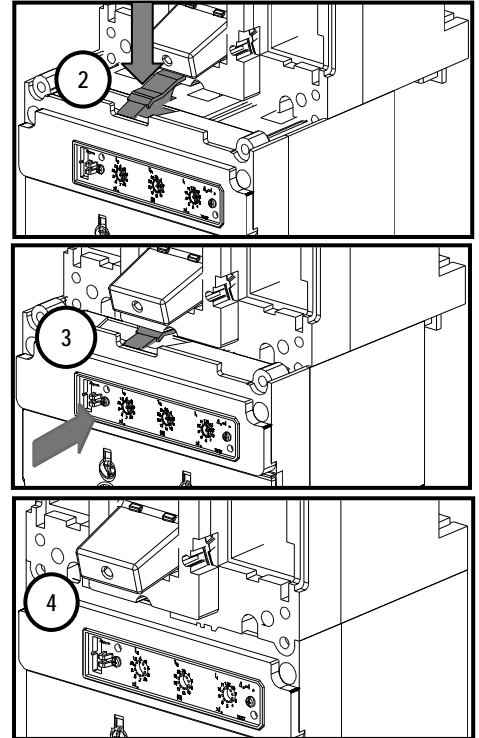
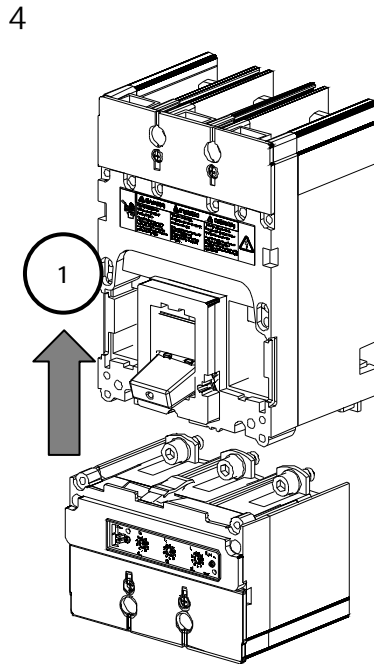
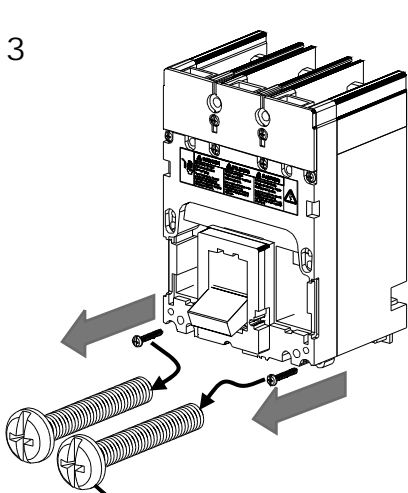
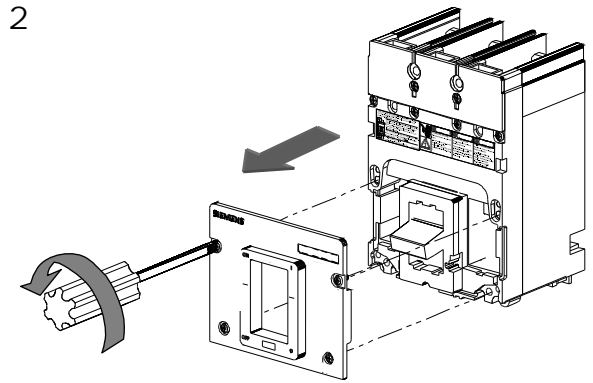
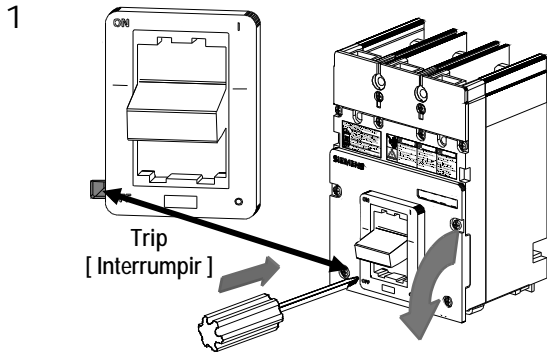



### Danger

**Hazardous Voltage**  
Will cause death or serious injury

Turn off and lock out all power supplying this device before working on this device.  
Replace all covers before power supplying this device is turned on.

### Peligro

**Tensión peligrosa.**  
Puede causar la muerte o lesiones graves.

Desenergice totalmente antes de instalar o darle servicio.  
Reemplace todas las barreras y cubiertas antes de energizar el interruptor.

### Danger!

**Tension dangereuse.**  
Danger de mort ou risque de blessures graves.

Couper l'alimentation de l'appareil et barrer avant de travailler.  
Remplacez tous les couverts avant que l'approvisionnement de pouvoir soit alimenté.

7

Ex: 400A

JG	LG
250A	400A
400A	600A

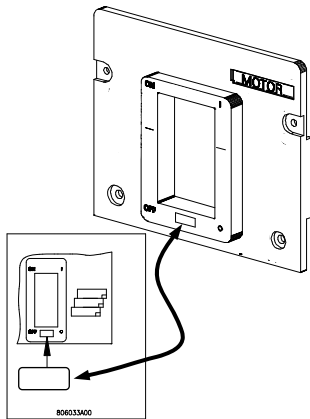

8

Ex: HJG3F400 / 3VL4040-2RA30-0AA0

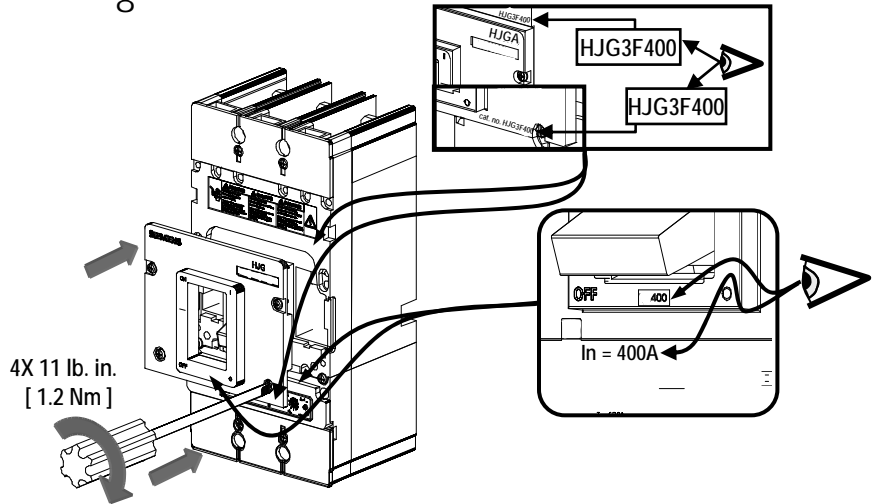

### Test: [ Prueba: ]

9

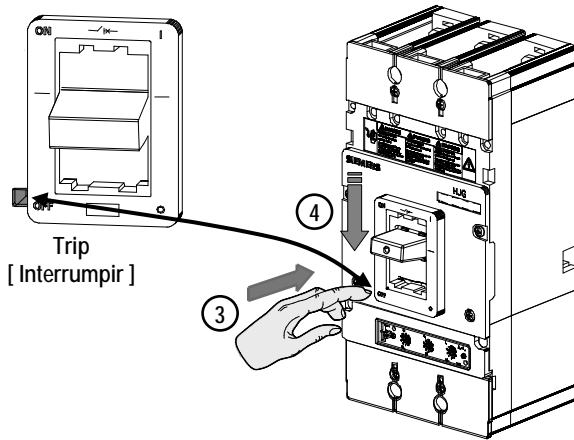
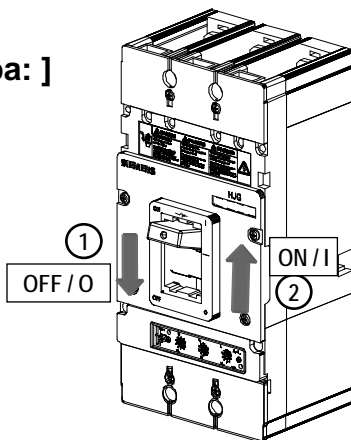

Trip  
[ Interrumpir ]

↓

OK

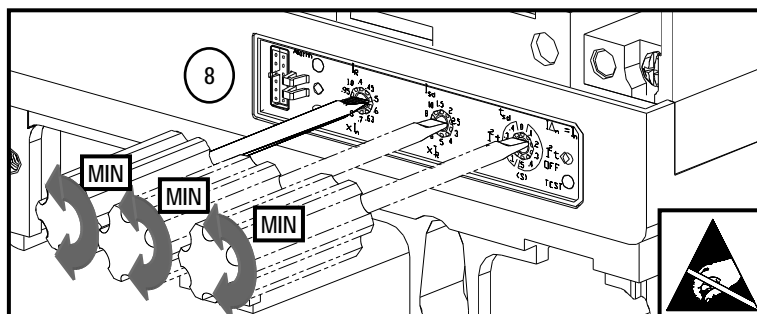
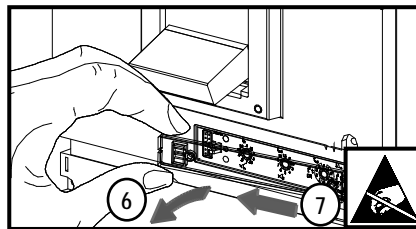
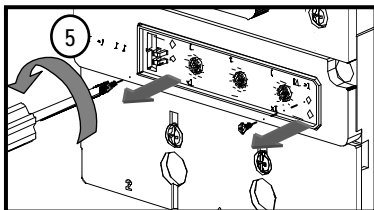

### Definitions / [Definiciones]

- $I_n$  = Rated Current  
[ Intensidad asignada ]
- $I_r$  = Continuous Amps  
[ Amperios Continuo ]
- $t_r$  = Long Time Delay  
[ Retardo largo ]
- $t_{sd}$  = Short Time Pickup  
[ Tiempo corto inicio ]
- $t_{sd}$  = Short Time Delay  
[ Retardo corto ]
- $I_i$  = Instantaneous Pickup  
[ Instantánea inicio ]
- $t_g$  = Ground Fault Pickup  
[ Inicio de Falla a Tierra ]
- $t_g$  = Ground Fault Delay  
[ Retardo de falla a tierra ]

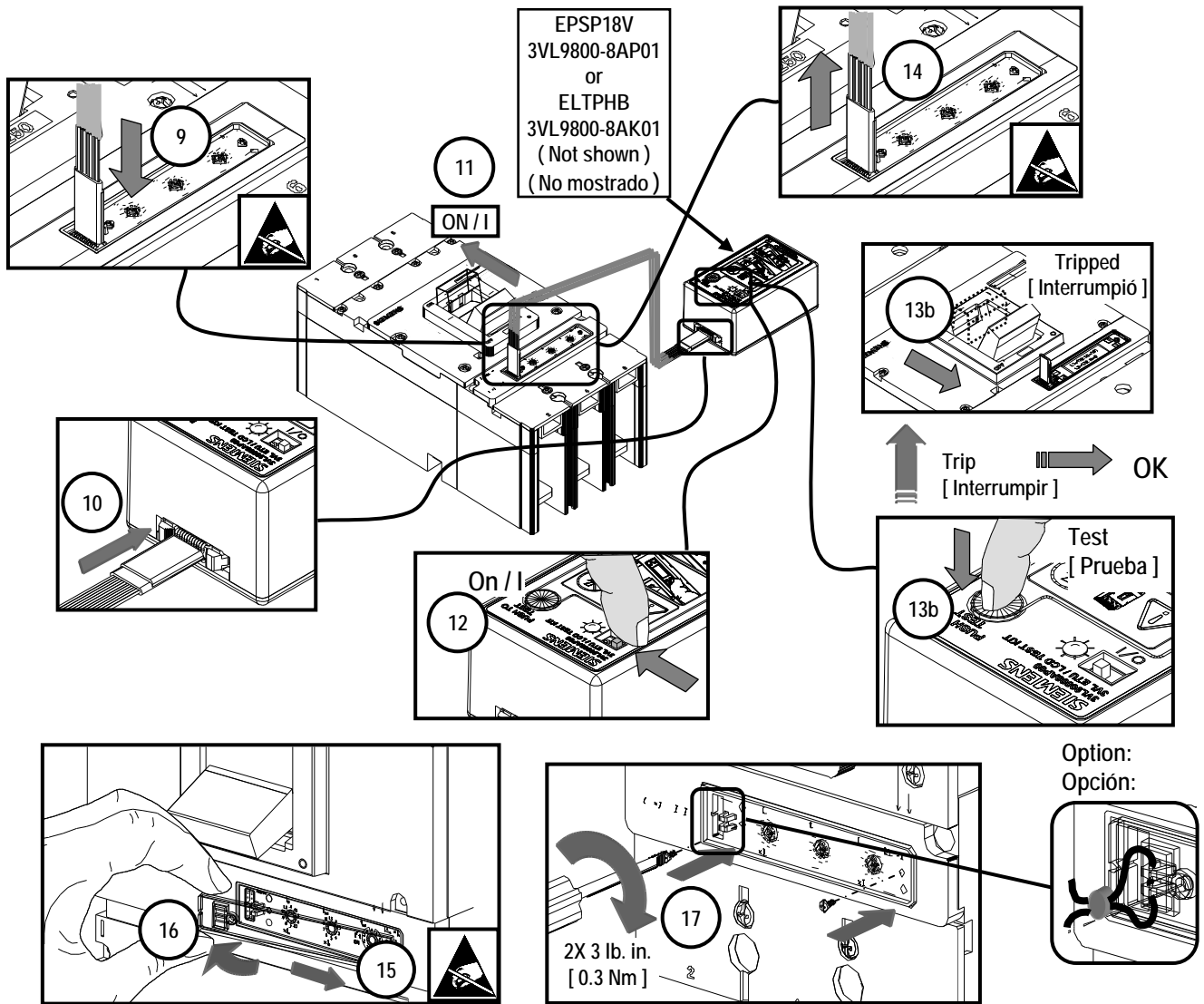

	<b>⚠ Danger</b>	<b>⚠ Peligro</b>	<b>⚠ Danger!</b>
	<b>Hazardous Voltage</b> Will cause death or serious injury Turn off and lock out all power supplying this device before working on this device. Replace all covers before power supplying this device is turned on.	<b>Tensión peligrosa.</b> Puede causar la muerte o lesiones graves. Desenergice totalmente antes de instalar o darle servicio. Reemplace todas las barreras y cubiertas antes de energizar el interruptor.	<b>Tension dangereuse.</b> Danger de mort ou risque de blessures graves. Couper l'alimentation de l'appareil et barrer avant de travailler. Remplacez tous les couverts avant que l'alimentation de pouvoir soit alimenté.

## L.E.D. Operational State [ L.E.D. Estado de Operación ]

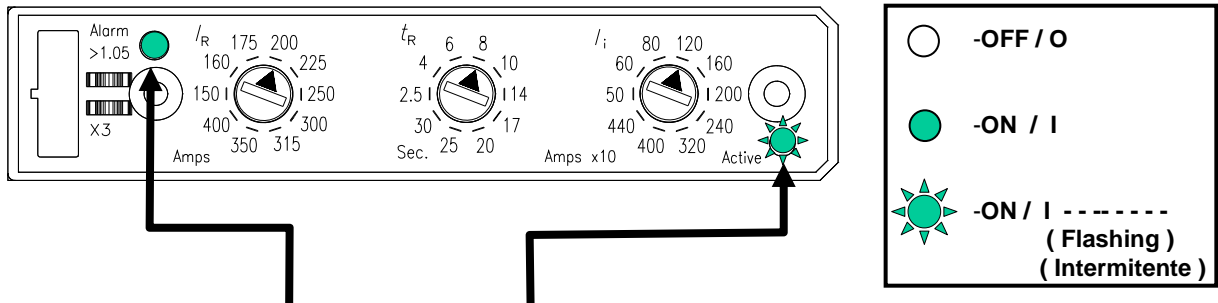

Operational State [ Estado de operación ]	Alarm L.E.D [ L.E.D de Alarma ]	Active L.E.D. [ L.E.D Activo ]	System Status [ Estado del sistema ]	Trip Unit Status [ Estado de la unidad de disparo ]
OK			$< 25\% I_n$	OK
OK			$< 105\% I_r$	OK
OK			$> 105\% I_r$	OK
Error	↔ <b>Alternating</b> [ Alternando ]		<b>Call Technical Support</b> [ Lamar a Soporte Técnico ]	<b>*Minimum Setting</b> [ * Ajuste de Minimo ]

\* In event of damage to the device, Electronic Trip Units are equipped with a Minimum Setting feature. All settings override to the lowest possible value and the device must be replaced.

[ \* En caso de daño al aparato, la unidad de disparo esta equipada con una característica de Ajuste de Minimo . Todos los ajuste se convierte al valor mas bajo posible y la unidad debe ser remplazada ]

Accessory  
[ Accesorio ]

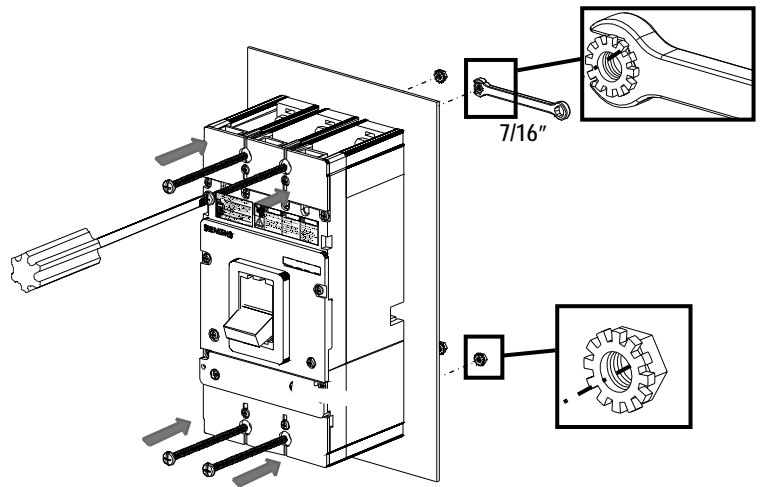
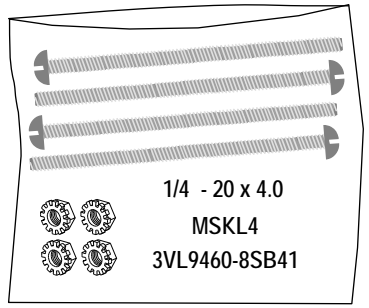

Accessory  
[ Accesorio ]

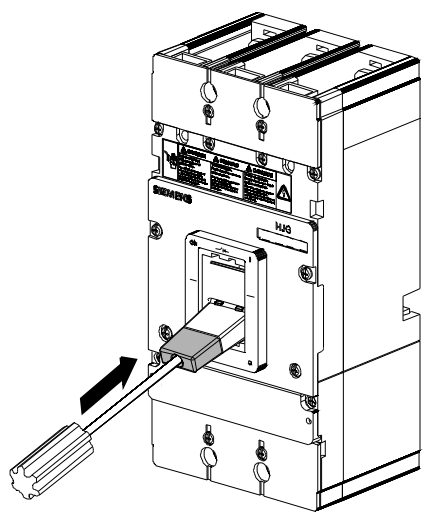
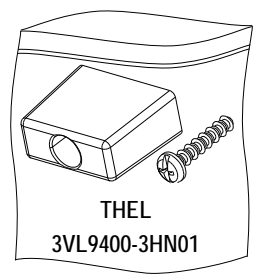

Accessory  
[ Accesorio ]

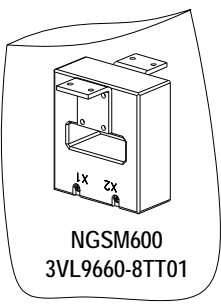
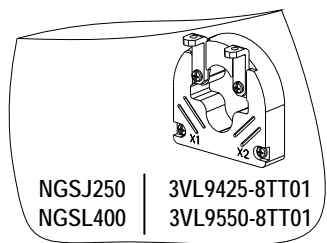

General Information  
[ Información General ]  
4 Pole Application example  
[ Aplicación ejemplo de 4 polos ]

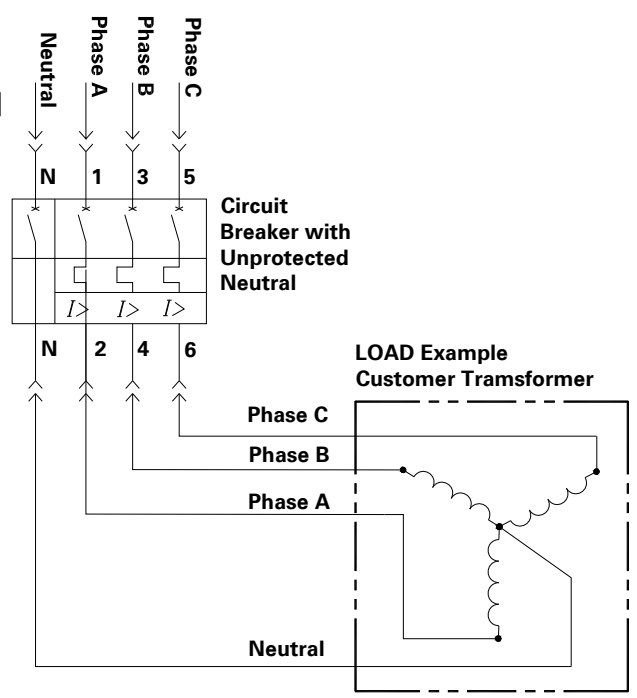

Bestell-Nr. / Order No.: 3ZX1012-0VL68-0AA3

For Support in Europe refer to :

Internet: [www.siemens.de/lowvoltage/technical-assistance](http://www.siemens.de/lowvoltage/technical-assistance)

GWA 4NEB 179 6812-10 DS 02

Technical Support:

Toll Free: 1-800-241-4453

Internet: [www.usa.siemens.com/powerdistribution](http://www.usa.siemens.com/powerdistribution)

Subject to change without prior notice  
Siemens Industry, Inc., Norcross, GA 30092 U.S.A.