

Data sheet for SIMOTICS S-1FS2

Article No. : 1FS2208-5AC07-1MZ0
Q0X



Figure similar

Client order no. :
Order no. :
Offer no. :
Remarks :

Item no. :
Consignment no. :
Project :

Basic motor data

Motor type	Permanent-magnet synchronous motor, Natural cooling, IP66/67 IP69K
Static torque	23.50 Nm
Static current	12.80 A
Maximum torque	80.00 Nm
Maximum current	51.5 A
Maximum speed	4,750 rpm
Rotor moment of inertia	49.1000 kgcm ²
Weight	28.0 kg

Rated data

SINAMICS S210, 3AC 400V

Rated speed	2,000 rpm
Rated torque	12.00 Nm
Rated current	7.1 A
Rated power	2.51 kW

Encoder system

Encoder system	Encoder AM22DQC: Absolute encoder 22 bit + 12 bit multiturn
----------------	---

Motor connection

Connection type	OCC for S210
Cable outlet	with open ends and direct inverter connection via IX connector
Cable length	11.0 m

Mechanical data

Design acc. to Code I	IM B5 (IM V1, IM V3)
Vibration severity grade	Grade A
Shaft height	78
Centering ring (N)	130 mm
Hole circle (M)	165 mm
Screw-on hole (S)	11.00 mm
Overall length (LB)	265 mm
Total length (L)	333 mm
Diameter of shaft (D)	32 mm
Length of shaft (E)	58 mm
Flange diameter (P)	198 mm
Shaft end	Fitted key

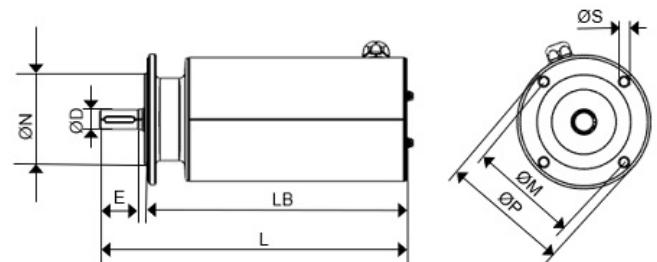

Special design

Q0X Cable outlet with open ends and direct inverter connection via IX connector, 11.0 m