

Accessory Circuit breaker 3WA, Grounding connection between guide frame a. circuit breaker. Contacting module for circuit breaker, frame size 3, 4 poles not for breaking capacity E



Model	
product brand name	SETRON
product designation	Grounding connection
design of the product	grounding connection between the guide frame and the circuit breaker
General technical data	
number of poles	4
size of the circuit-breaker	2
switching capacity class of the circuit breaker	S, M, H, D, C

Approvals Certificates		
General Product Approval	EMV	Test Certificates



[Miscellaneous](#)

[Special Test Certificate](#)

Maritime application	other	Dangerous goods
----------------------	-------	-----------------



[Confirmation](#)

[Dangerous goods information](#)

Further information

Information on the packaging

<https://support.industry.siemens.com/cs/ww/en/view/109813875>

Information- and Downloadcenter (Catalogs, Brochures,...)

<http://www.siemens.com/lowvoltage/catalogs>

Industry Mall (Online ordering system)

<https://mall.industry.siemens.com/mall/en/en/Catalog/product?mlfb=3WA9111-0BG23>

Service&Support (Manuals, Certificates, Characteristics, FAQs,...)

<https://support.industry.siemens.com/cs/ww/en/ps/3WA9111-0BG23>

Image database (product images, 2D dimension drawings, 3D models, device circuit diagrams, ...)

http://www.automation.siemens.com/bilddb/cax_en.aspx?mlfb=3WA9111-0BG23

CAx-Online-Generator

<http://www.siemens.com/cax>

Tender specifications

<http://www.siemens.com/specifications>

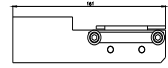

last modified:

4/13/2025 