

Two-hand operation console for command devices, 22 mm, round, Enclosure material plastic, enclosure top part gray, 3 control points plastic, without equipment, with cable cut-outs for metric screw connections



<b>Product brand name</b>	SIRIUS ACT
<b>Product designation</b>	Two-hand operation console
<b>Product type designation</b>	3SU1
<b>Enclosure</b>	
<b>Design of the housing</b>	Two-hand operating console without standard equipment
<b>Material of the enclosure</b>	plastic
<b>Number of command points</b>	3
<b>Color</b>	
• of top part of the enclosure	grey
<b>Delivery state</b>	
• as a kit	No
• pre-wired on strip terminal	No
<b>Mounting type of the enclosure</b>	Horizontal
<b>Actuator</b>	
<b>Design of the operating mechanism</b>	Unequipped
<b>Manner of function of the actuating element</b>	without
<b>Product feature</b>	
• lockout	No

• staggered switching	No
<b>Number of contact modules</b>	0

#### General technical data

<b>Product function</b>	
• positive opening	No
• EMERGENCY OFF function	No
• EMERGENCY STOP function	No
<b>Product component</b>	
• Stand/pedestal	No
<b>Protection class IP</b>	IP66
<b>Degree of protection NEMA rating</b>	NEMA 1, 4X, 12K, indoor use only, 13
<b>Shock resistance</b>	
• acc. to IEC 60068-2-27	Sinusoidal half-wave 50 g / 11 ms
<b>Reference code acc. to DIN EN 81346-2</b>	U
<b>Reference code acc. to DIN EN 61346-2</b>	U

#### Auxiliary circuit

<b>Number of NC contacts for auxiliary contacts</b>	0
<b>Number of NO contacts for auxiliary contacts</b>	0
<b>Number of CO contacts</b>	
• for auxiliary contacts	0

#### Connections/Terminals

<b>Type of electrical connection on enclosure</b>	Cable routing at the rear 2 x M25
---	-----------------------------------

#### Ambient conditions

<b>Ambient temperature</b>	
• during operation	-25 ... +70 °C
• during storage	-40 ... +80 °C
Environmental category during operation acc. to IEC 60721	3M6, 3S2, 3B2, 3C3, 3K6 (with relative air humidity of 10 ... 95 %, no condensation in operation permitted for all devices behind front panel)

#### Installation/ mounting/ dimensions

<b>(height)</b>	185.3 mm
<b>Width</b>	469.2 mm
<b>Depth</b>	137.4 mm

#### Accessories

<b>Number of backing plates</b>	0
---------------------------------	---

#### Certificates/approvals

<b>General Product Approval</b>	<b>Declaration of Conformity</b>
---------------------------------	----------------------------------



CCC



UL



VDE



EG-Konf.

[Miscellaneous](#)

<b>Test Certificates</b>	<b>Marine / Shipping</b>
--------------------------	--------------------------

[Type Test Certificates/Test Report](#)



ABS



LRS



PRS



RINA



RMRS

<b>Marine / Shipping</b>	<b>other</b>
--------------------------	--------------



DNVGL.COM/AF

[Confirmation](#)

**Further information**

**Information- and Downloadcenter (Catalogs, Brochures,...)**

<http://www.siemens.com/industrial-controls/catalogs>

**Industry Mall (Online ordering system)**

<https://mall.industry.siemens.com/mall/en/en/Catalog/product?mlfb=3SU1803-3AA00-0AA1>

**Cax online generator**

<http://support.automation.siemens.com/WW/CAXorder/default.aspx?lang=en&mlfb=3SU1803-3AA00-0AA1>

**Service&Support (Manuals, Certificates, Characteristics, FAQs,...)**

<https://support.industry.siemens.com/cs/ww/en/ps/3SU1803-3AA00-0AA1>

**Image database (product images, 2D dimension drawings, 3D models, device circuit diagrams, EPLAN macros, ...)**

[http://www.automation.siemens.com/bilddb/cax\\_de.aspx?mlfb=3SU1803-3AA00-0AA1&lang=en](http://www.automation.siemens.com/bilddb/cax_de.aspx?mlfb=3SU1803-3AA00-0AA1&lang=en)

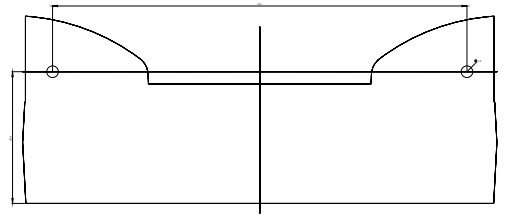
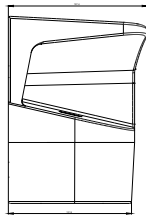
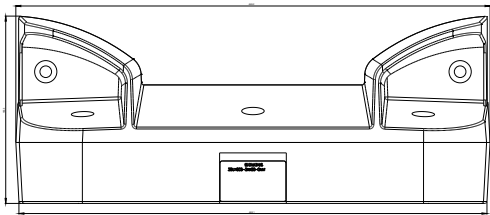

last modified:

07/24/2019