

2

1

PANDUIT P/N	WEIGHT
P18B21M	4.6kg

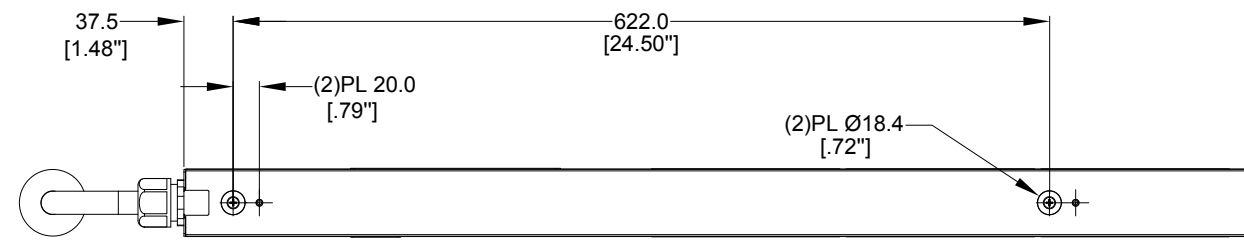

REAR VIEW

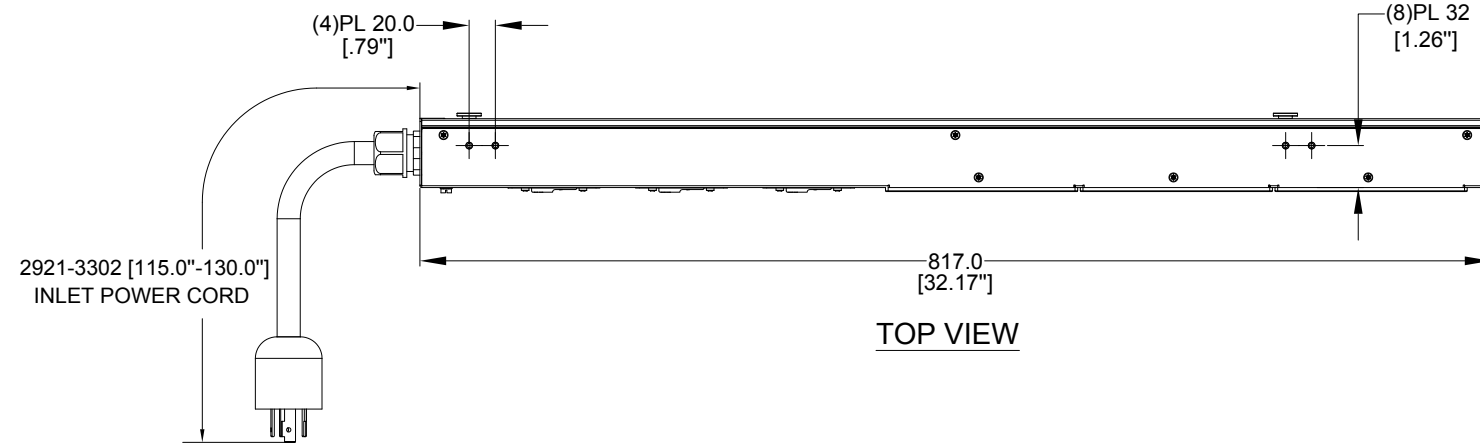

TOP VIEW

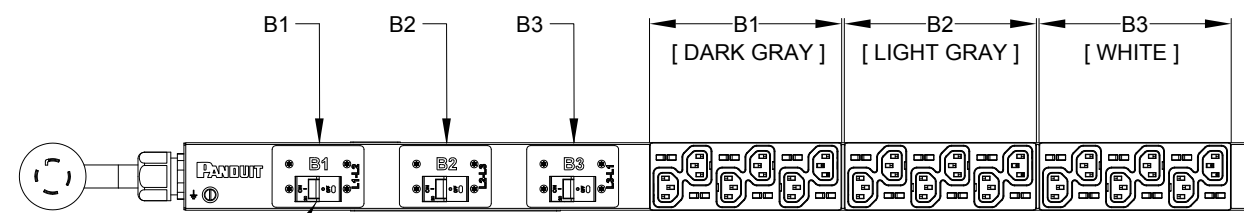

FRONT VIEW

20 AMP, DOUBLE - POLE
ELECTRO MECHANICAL
SWITCH / BREAKER (3) PLACES

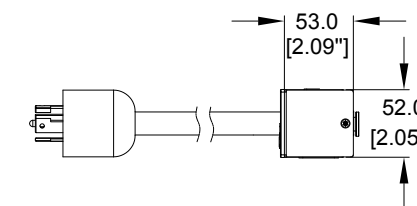

SIDE VIEW

NOTES:

1. IDENTIFICATION:
- | | |
|--------------------|------------------------|
| UNIT TYPE: | BASIC |
| ORIENTATION: | VERTICAL, HALF |
| OUTLET QTY&TYPE: | (18) C13 |
| BREAKER QTY&TYPE: | (3) 20AMP, DOUBLE-POLE |
| INPUT VOLTAGE: | 200-240VAC, DELTA |
| INPUT CURRENT: | 30A (24A DERATED) |
| INPUT PHASE: | THREE-PHASE DELTA |
| RATED POWER: | 8.6kVA |
| INPUT PLUG: | NEMA L15-30P |
| INPUT CORD LENGTH: | 3m [10'] |
2. ACCESSORIES:
POCKET GUIDE
3. RoHS COMPLIANT
4. VISIT PANDUIT'S ON-LINE CATALOG AT WWW.PANDUIT.COM FOR ADDITIONAL PRODUCT INFORMATION CONTAINED IN THE SPECIFICATION SHEET AS WELL AS A CURRENT LIST OF PRODUCTS APPLICABLE FOR USE WITH THIS PART
5. MAXIMUM ALLOWABLE INPUT POWER = 8.6kW
6. INSTALLATION SHALL COMPLY WITH ALL APPLICABLE NATIONAL, STATE, AND LOCAL CODES

B

B

A

A

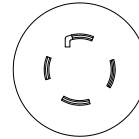

PLUG
30 AMP, 250V x 3~ DELTA
TWIST LOCK
NEMA L15-30P

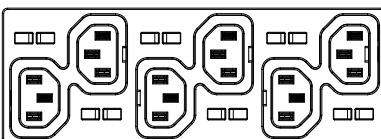

**EIGHTEEN (18)
RECEPTACLES**
10 AMP, 250V
STRAIGHT BLADE
IEC 60320 / C13

REV	DATE	BY	CHK	APR	DESCRIPTION	ECN
01B	08/21/2017	JIANG	MIM	EDM	REVISED TOLERANCES	P18B21M
01A	06/28/2017	JIANG	MIM	EDM	INITIAL RELEASE	P18B21M

WE ASK THAT YOU CHECK FULLY THE DIMENSIONS, NOTES, AND SIGN THE CLIENT SIGNATURE BOX. THE JOB WILL NOT PROGRESS WITHOUT SIGNED APPROVAL. PLEASE DO NOT DELAY IN RETURNING PROOF AS IT WILL AFFECT DELIVERY		SIGN
		DATE
		PRINT
TITLE BASIC SERIES PDU P18B21M CUSTOMER DRAWING		
ITEM REVISION NAME		
DATASHEET FILE NAME:		
UNLESS OTHERWISE SPECIFIED DIMENSIONAL TOLERANCE ARE: mm [IN]		MATERIAL/COLOR:
Tolerance(mm)		N/A
0.4<L<50 ±0.5		DRAWING NUMBER:
50<L<250 ±1.0		P18B21M_DC
250<L<500 ±1.5		SHT 1 OF 1
500<L<1000 ±2.5		SCALE
1000<L<2000 ±4.0		B
DRAWN BY	DATE	SCALE
JIANG	05/24/2017	NONE
CHK	SCALE	
SEAN		

2

1