

circuit breaker VL400X UL; type LG (cat no. HLK3T600) non-interchangeable frame, with circuit breaker approval acc. to UL 489 high breaking capacity 3-pole, NEMA rating 65kA/480V and 18kA/600V (molded case circuit breaker) trip unit ETU, LSI TA=40°C In=600A, rated current ISD=1.5 to 9xIR, II=10xIN short-circuit protection IR=200-600A ETU for line protection without connection accessories without auxiliary release without auxiliary/alarm switch

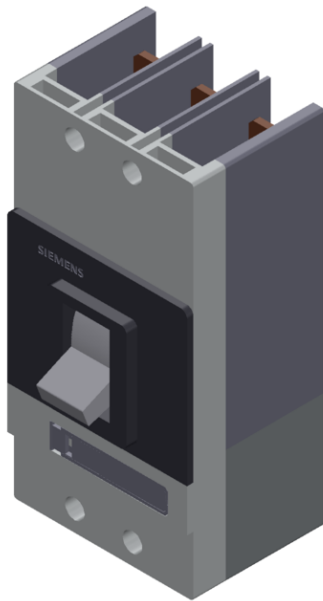

Model	
Type of the driving mechanism / motor drive	No
Design of the overcurrent release	ETU545
General technical data	
Number of poles	3
Size of the circuit-breaker	3VL4X UL
Electrical endurance (switching cycles) / typical	10 000

Usage category	A
Performance class for circuit breaker	N
Mechanical service life (switching cycles) / typical	20 000
Reference code / acc. to DIN 40719 extended according to IEC 204-2 / acc. to IEC 750	Q
Operating frequency / maximum	120 1/s

Voltage

Rated operational voltage U _e / max.	690 V
Insulation voltage / rated value	800 V
Surge voltage resistance / rated value	8 kV
Operating voltage	
• rated value / maximum	690 V
• for main current circuit / at AC / at 50 Hz / acc. to UL 489 / maximum	600 V
• for main current circuit / at AC / at 50 Hz / maximum	690 V
• for main current circuit / at AC / at 60 Hz / acc. to UL 489 / maximum	600 V
• for main current circuit / at AC / at 60 Hz / maximum	690 V

Protection class

Protection class IP	IP20
Protective function of the overcurrent release	LSI

Current

Operating current / at 45 °C / rated value	570 A
Continuous current / rated value	600 A
Derating temperature / for the rated value of the continuous current	
• acc. to UL 489	40 °C

Main circuit

Operating frequency	
• 1 / rated value	50 Hz
• 2 / rated value	60 Hz
Operating current	
• at 40 °C / rated value	600 A
• at 50 °C / rated value	570 A
• at 55 °C / rated value	480 A
• at 60 °C / rated value	480 A

Auxiliary circuit

Number of CO contacts / for auxiliary contacts	0
Number of NC contacts / for auxiliary contacts	0

Number of NO contacts / for auxiliary contacts	0
--	---

Suitability

Suitability for use	system/generator protection
---------------------	-----------------------------

Product details

Product component	
• Trip indicator	No
• Auxiliary switch	No
• Voltage trigger	No
• undervoltage release	No
• undervoltage release with leading contact	No
Product extension / optional / motor drive	Yes

Product function

Product function	
• of thermal overload trip unit	adjustable
• Ground fault protection	No
• for neutral conductors / Short-circuit and overload proof	No
• Overload protection	Yes

Short circuit

Operational short-circuit current breaking capacity (Ics)	
• at 240 V / rated value	75 kA
• at 415 V / rated value	70 kA
• at 690 V / rated value	8 kA
Maximum short-circuit current breaking capacity (Icu)	
• at 240 V / rated value	100 kA
• at 415 V / rated value	70 kA
• at 480 V / acc. to NEMA / rated value	65 kA
• at 600 V / acc. to NEMA / rated value	18 kA
• at 690 V / rated value	15 kA

Connections

Arrangement of electrical connectors / for main current circuit	front side
Type of electrical connection / for main current circuit	without connection accessoires

Mechanical Design

Height	279.5 mm
Width	139.5 mm
Depth	163.5 mm
Mounting type	fixed mounting

Certificates

Certificate of suitability	UL Stretch, high switching capacity (H), non-interchangeable
Reference code	Q

- acc. to DIN EN 61346-2

General Product Approval	EMC	Declaration of Conformity
---------------------------------	------------	----------------------------------



[Miscellaneous](#)



Test Certificates	Shipping Approval	other			
--------------------------	--------------------------	--------------	--	--	--

[Special Test Certificate](#)



[Environmental Confirmations](#)

[Miscellaneous](#)

[Confirmation](#)

[Manufacturer Declaration](#)

Further information

Information- and Downloadcenter (Catalogs, Brochures,...)

<http://www.siemens.com/lowvoltage/catalogs>

Industry Mall (Online ordering system)

<https://mall.industry.siemens.com/mall/en/en/Catalog/product?mlfb=3VL4860-2PE30-0AA0>

Service&Support (Manuals, Certificates, Characteristics, FAQs,...)

<https://support.industry.siemens.com/cs/ww/en/ps/3VL4860-2PE30-0AA0>

Image database (product images, 2D dimension drawings, 3D models, device circuit diagrams, ...)

http://www.automation.siemens.com/bilddb/cax_en.aspx?mlfb=3VL4860-2PE30-0AA0

CAX-Online-Generator

<http://www.siemens.com/cax>

Tender specifications

<http://www.siemens.com/specifications>