

Electronic Trip Unit

Disparador por sobreintensidad electrónico

Déclencheur électronique

	U.S. Cat. No.	Euro Order No.
Item:	CDT3N ___	3VL92 ___ - 6GB38
	CDT3P ___	3VL92 ___ - 6GE38
	CDT3U ___	3VL92 ___ - 6GH38
	CDT3X ___	3VL92 ___ - 6GD38
	CFT3N ___	3VL93 ___ - 6GB38
	CFT3P ___	3VL93 ___ - 6GE38
	CFT3U ___	3VL93 ___ - 6GH38
	CFT3X ___	3VL93 ___ - 6GD38

For Use With Frame DG, FG
Para Usar Con Caja Base DG, FG

Installation Instructions / Instructivo de Instalación

	 Danger	 Peligro	 Danger!
	Hazardous Voltage Will cause death or serious injury Turn off and lock out all power supplying this device before working on this device. Replace all covers before power supplying this device is turned on.	Tensión peligrosa. Puede causar la muerte o lesiones graves. Desenergice totalmente antes de instalar o darle servicio. Reemplace todas las barreras y cubiertas antes de energizar el interruptor.	Tension dangereuse. Danger de mort ou risque de blessures graves. Couper l'alimentation de l'appareil et barrer avant de travailler. Remplacez tous les couverts avant que l'alimentation de pouvoir soit alimenté.

Use only with Siemens certified Components.

Utilizar únicamente con componentes certificados de Siemens.

A utiliser uniquement avec les composants certifiés Siemens.

NOTE - These instructions do not purport to cover all details or variations in equipment, or to provide for every possible contingency to be met in connection with installation, operation or maintenance. Should further information be desired or should particular problems arise, which are not covered sufficiently for the purchaser's purposes, the matter should be referred to the local Siemens sales office. The contents of this instruction manual shall not become part of or modify any prior or existing agreement, commitment or relationship. The sales contract contains the entire obligation of Siemens. The warranty contained in the contract between the parties is the sole warranty of Siemens. Any statements contained herein do not create new warranties or modify the existing warranty.

Trademarks - Unless otherwise noted, all names identified by ® are registered trademarks of Siemens AG or Siemens Industry, Inc. The remaining trademarks in this publication may be trademarks whose use by third parties for their own purposes could violate the rights of the owner.

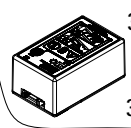

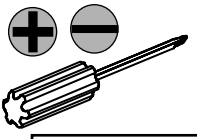

EPSP18V
3VL90008AP01
OR
ELTPHB
3VL9000-8AK01

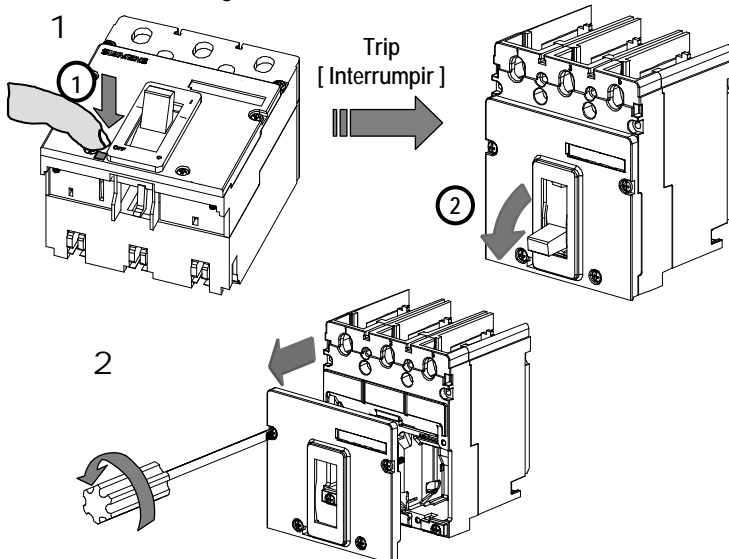

CAL ISO 6789

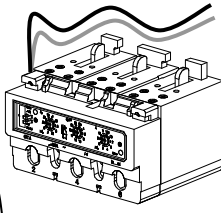
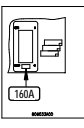

	CDT3U060	3VL9206-6GH38
	CDT3U100	3VL9210-6GH38
	CDT3U150	3VL9215-6GH38
	CDT3X060	3VL9206-6GD38
	CDT3X100	3VL9210-6GD38
	CDT3X150	3VL9215-6GD38
 	CFT3U100	3VL9310-6GH38
	CFT3U150	3VL9315-6GH38
	CFT3U250	3VL9325-6GH38
	CFT3X100	3VL9310-6GD38
	CFT3X150	3VL9315-6GD38
	CFT3X250	3VL9325-6GD38

178.4040.04

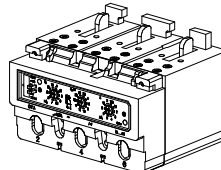
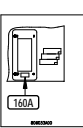
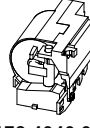
	CDT3N060	3VL9206-6GB38
	CDT3N100	3VL9210-6GB38
	CDT3N150	3VL9215-6GB38
	CDT3P060	3VL9206-6GE38
	CDT3P100	3VL9210-6GE38
	CDT3P150	3VL9215-6GE38
 	CFT3N100	3VL9310-6GB38
	CFT3N150	3VL9315-6GB38
	CFT3N250	3VL9325-6GB38
	CFT3P100	3VL9310-6GE38
	CFT3P150	3VL9315-6GE38
	CFT3P250	3VL9325-6GE38

178.4040.04



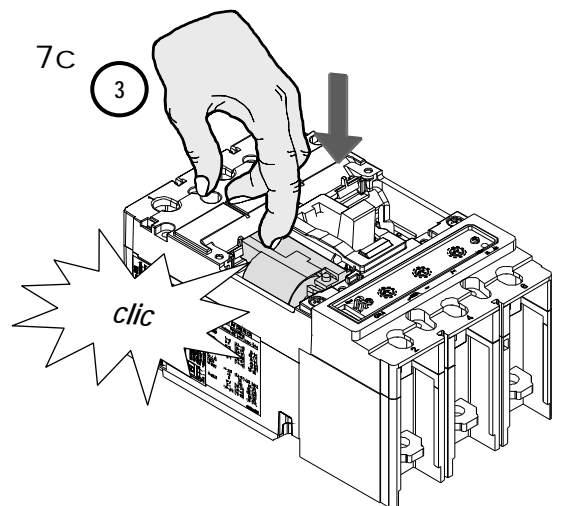
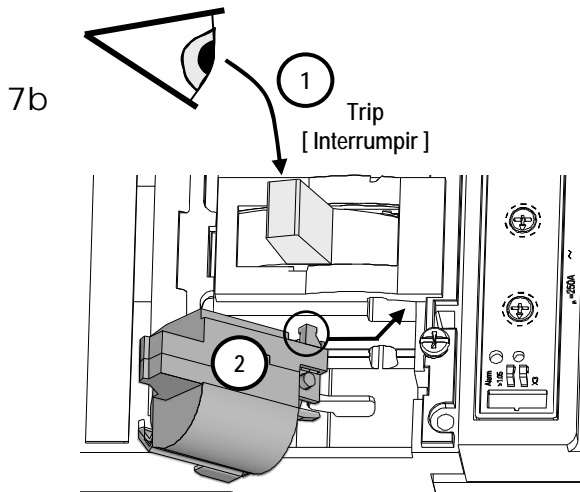
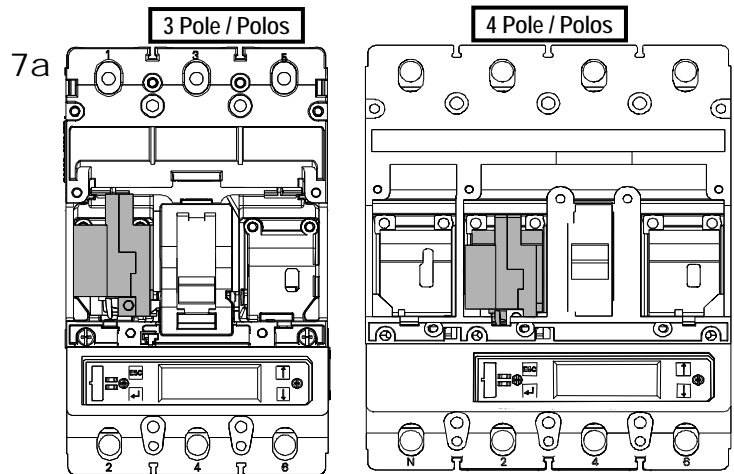
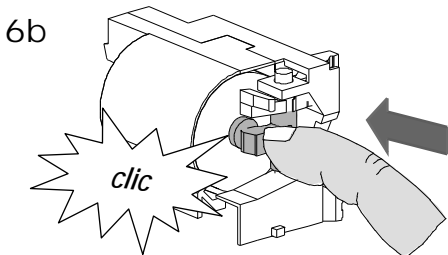
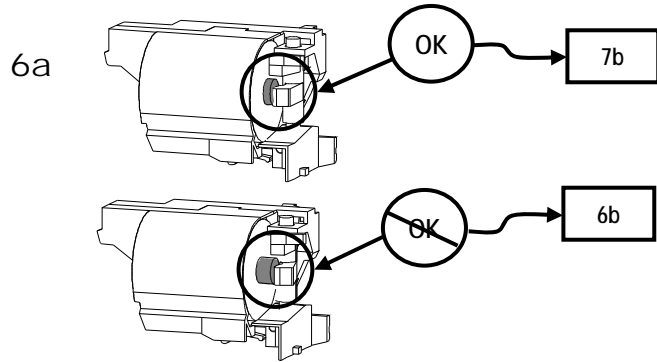
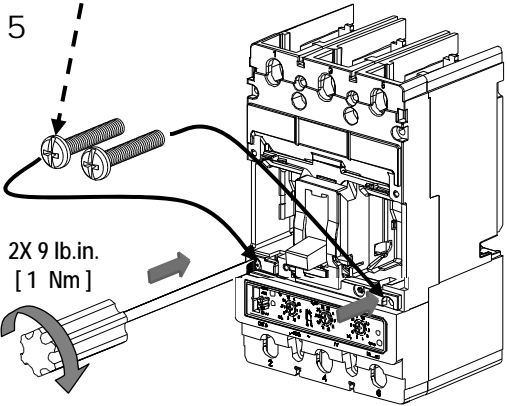
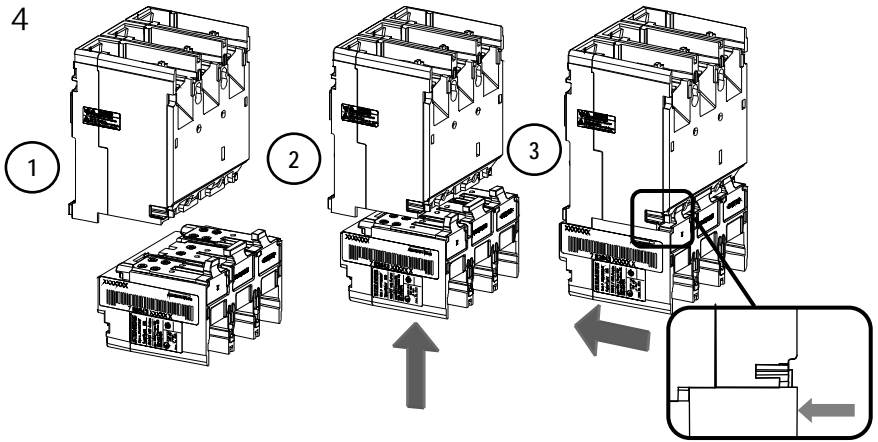
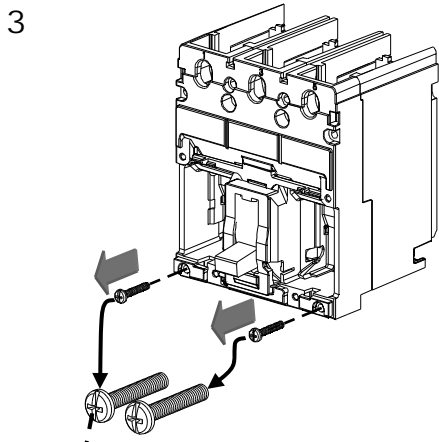



Danger

Hazardous Voltage
Will cause death or serious injury



Turn off and lock out all power supplying this device before working on this device.
Replace all covers before power supplying this device is turned on.

Peligro

Tensión peligrosa.
Puede causar la muerte o lesiones graves.
Desenergice totalmente antes de instalar o darle servicio.
Reemplace todas las barreras y cubiertas antes de energizar el interruptor.

Danger!

Tension dangereuse.
Danger de mort ou risque de blessures graves.
Couper l'alimentation de l'appareil et barrer avant de travailler.
Remplacez tous les couverts avant que l'alimentation de pouvoir soit alimenté.

8 Ex: 250A

DG	FG
60A	100A
100A	150A
150A	250A

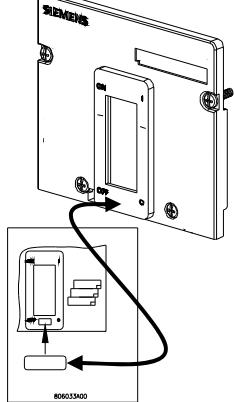

9

Ex: HFG3F250 / 3VL3025-2RA30-0AA0

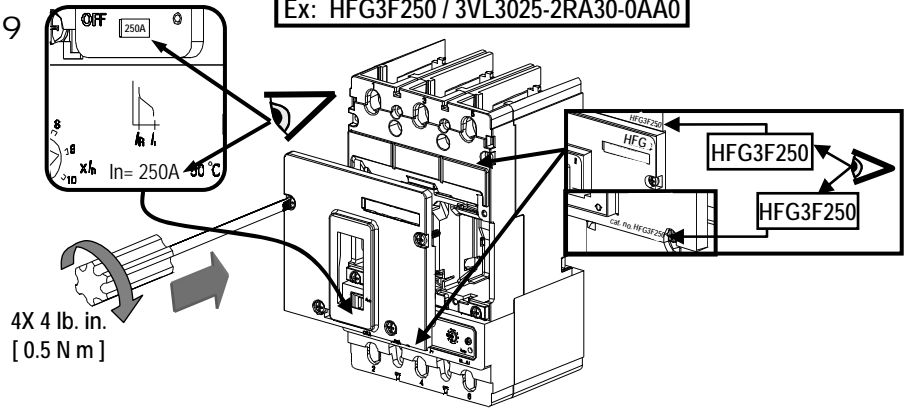

Test: [Prueba:]

10

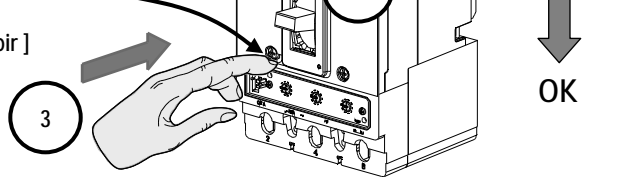
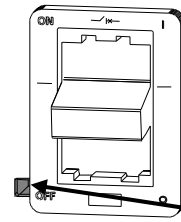
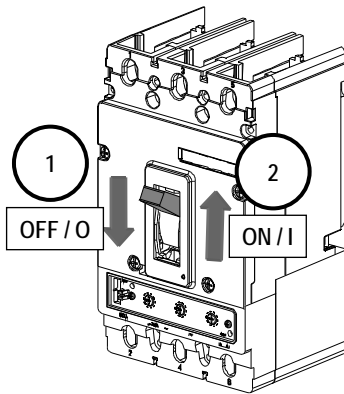

Trip
[Interrupir]
OK

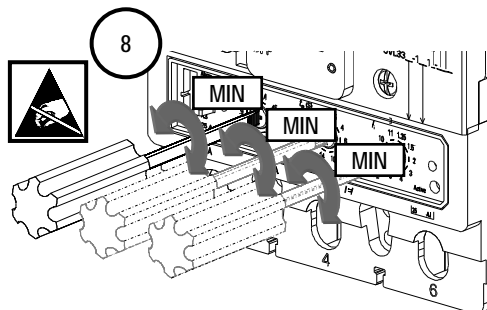
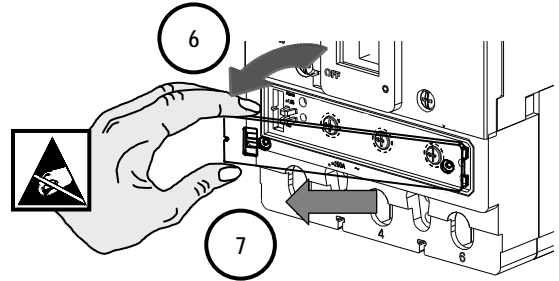
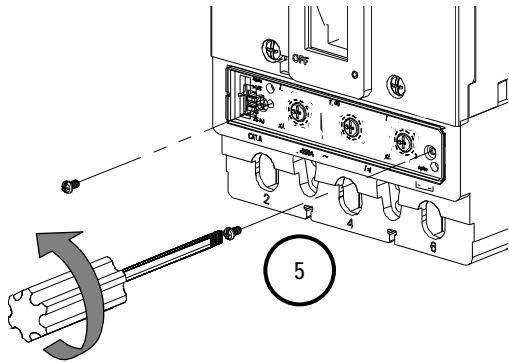

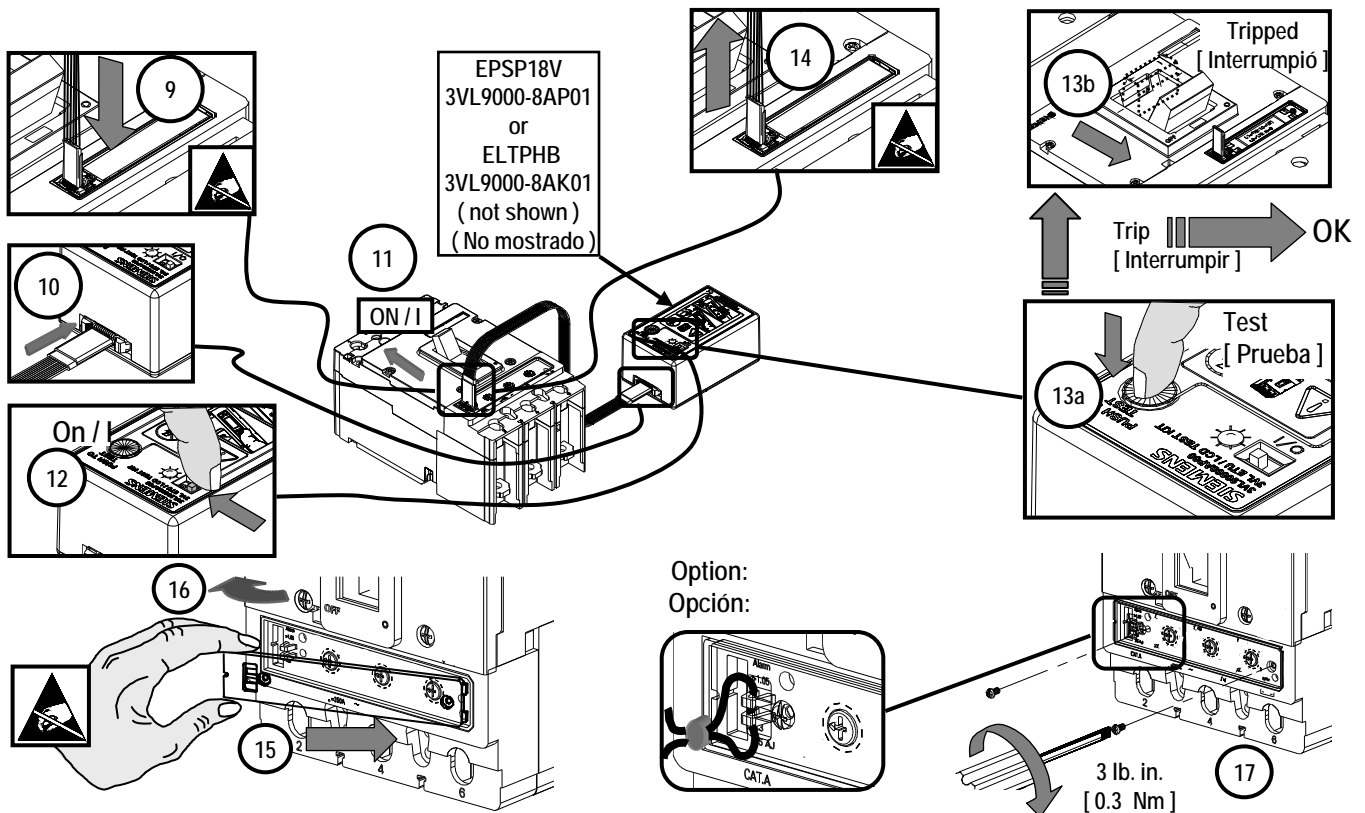

L.E.D. Operational States [L.E.D. Estado operación]

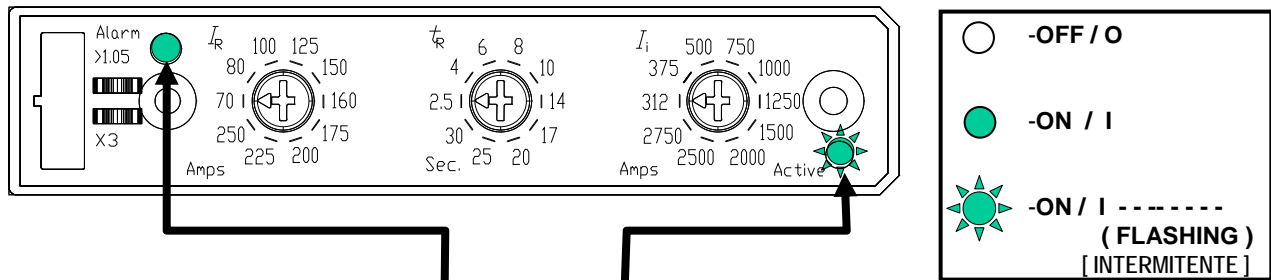

Operational State [Estado de operación]	Alarm L.E.D [L.E.D de Alarma]	Active L.E.D. [L.E.D Activo]	System Status [Estado del sistema]	Trip Unit Status [Estado de la unidad de disparo]
OK	○	○	$< 25\% I_n$	OK
OK	○	★	$< 105\% I_r$	OK
OK	●	★	$> 105\% I_r$	OK
Error	★ ↔ ★ Alternating [Alternando]		Call Technical Support [Llamar a Soporte Técnico]	*Minimum Setting [* Ajuste de Minimo]

* In event of damage to the device, Electronic Trip Units are equipped with a Minimum Setting feature. All settings override to the lowest possible value and the device must be replaced.

[* En caso de daño al aparato, la unidad de disparo esta equipada con una característica de Ajuste de Minimo . Todos los ajuste se convierte al valor mas bajo posible y la unidad debe ser remplazada]



Danger

Hazardous Voltage

Will cause death or serious injury

Turn off and lock out all power supplying this device before working on this device.

Replace all covers before power supplying this device is turned on.



Peligro

Tensión peligrosa.

Puede causar la muerte o lesiones graves.

Desenergice totalmente antes de instalar o darle servicio.

Reemplace todas las barreras y cubiertas antes de energizar el interruptor.



Danger!

Tension dangereuse.

Danger de mort ou risque de blessures graves.

Couper l'alimentation de l'appareil et barrer avant de travailler.

Remplacez tous les couverts avant que l'alimentation de pouvoir soit alimenté.

Accessory [Accesorio]

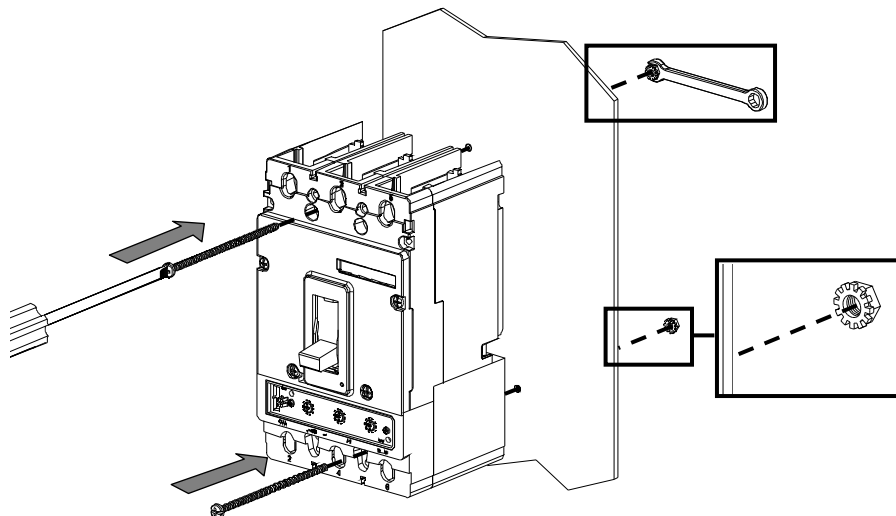
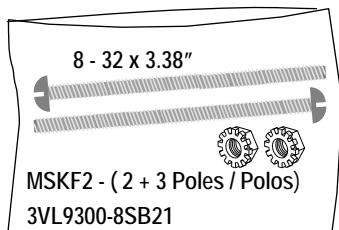

Accessory [Accesorio]

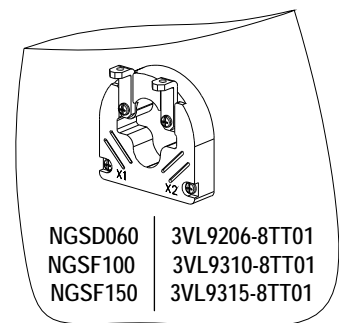

NGSD060	3VL9206-8TT01
NGSF100	3VL9310-8TT01
NGSF150	3VL9315-8TT01

Bestell-Nr. / Order No.: 3ZX1012-0VL68-0AA2

For Support in Europe refer to :

Internet: www.siemens.de/lowvoltage/technical-assistance

GWA 4NEB 179 6811-10 DS 02

Technical Support:

Toll Free: 1-800-241-4453

Internet: www.usa.siemens.com/powerdistribution

Subject to change without prior notice
Siemens Industry, Inc., Norcross, GA 30092 U.S.A.

Mounting Template / [Patrón para el Montaje]

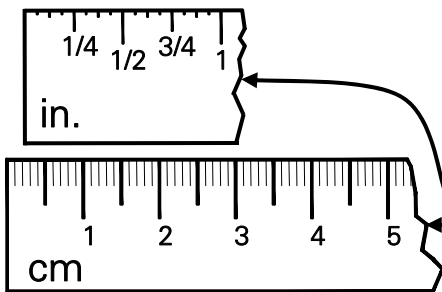
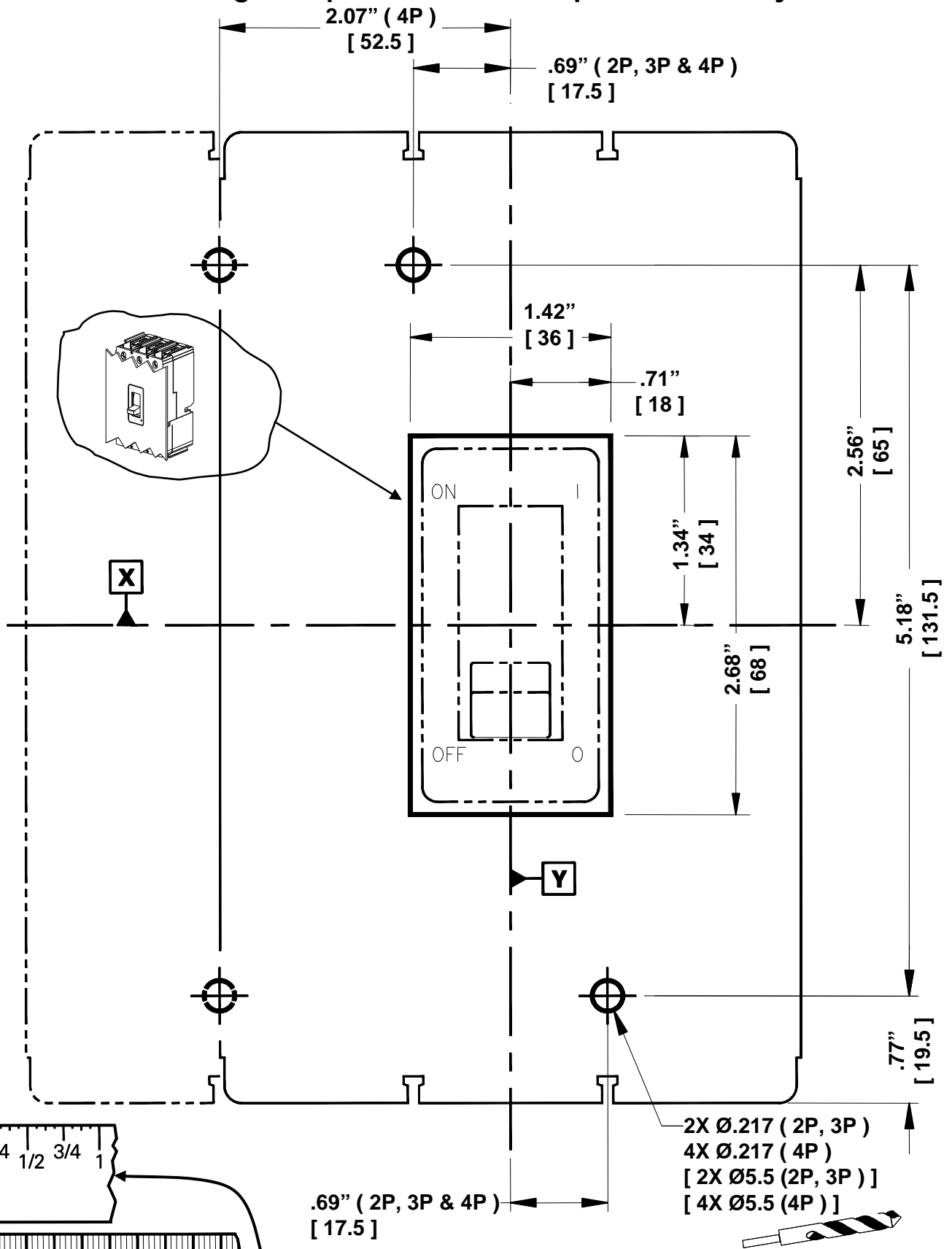

Verify 1:1 scale before using
[Verifique la escala de 1:1 antes de usar]

