

Cable Entry Systems

Cable Entry Gland Plate Connected Outside, CCFO

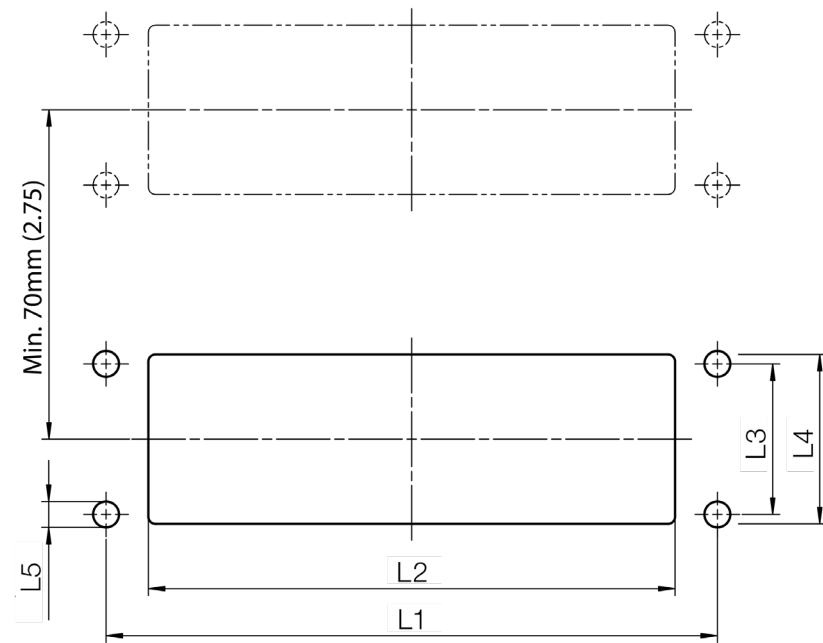

Cutout Dimensions

Frame	Catalog Number	L1 (mm/in.)	L2 (mm/in.)	L3 (mm/in.)	L4 (mm/in.)	L5 (mm/in.)
Outside Modular cable entry 1/4	CCFO14	58/2.28	46/1.81	32/1.26	36-46 1.42-1.81	5.5/.22
Outside Modular cable entry 6/10	CCFO610	83/3.27	68.5/2.70	32/1.26	36-46 1.42-1.81	5.5/.22
Outside Modular cable entry 8/16	CCFO816	103/4.06	91/3.58	32/1.26	36-46 1.42-1.81	5.5/.22
Outside Modular cable entry 10/24	CCFO1024	130/5.12	113.5/4.47	32/1.26	36-46 1.42-1.81	5.5/.22

Usage Options

Frame	INLAY			
	1 CCFD1	2 CCFD2	4 CCFD4	6 CCFD6
Outside Modular cable entry 1/4			x	
Outside Modular cable entry 6/10		x		x
Outside Modular cable entry 8/16	x		x	
Outside Modular cable entry 10/24		x	x	x

INSTALLATION

- 1** We recommend 4 M5 screws with length to account for 3mm thick gland plate, plus thickness of your enclosure.
- 2** Insert washers and nuts. Tighten nuts from inside, 3 Nm (26 in-lbs).
- 3** Guide cables through frame.
- 4** Click inlays into position.
- 5** Attach seals to cables.
- 6** Push seals all the way in.
- 7** Assemble hood.
- 8** Snap hood onto frame.
- 9** Snap the optional locking bars into position in the frame.
TO REMOVE THE HOOD: Remove optional locking bars. Press tabs on sides and pull apart.



According to UL Standard 508A, the following Conditions of Acceptability apply:

- Use M5 screws of stainless steel (AISI type 304 or 316)
- Max. end-use temperature for UL application is 50° C (52° F)
- Max. temperature range: -40° C to 120° C (-40° to 248° F) static