

Rear wall for cradle (guide frame), with vertical connections, Frame Size 2, 3-pole, for 3WA2 breaking capacity class C, $I_n = 2000A$, 1 piece, mounting possible on the top or bottom



Approvals Certificates

General Product Approval

EMV

Test Certificates

other



[Miscellaneous](#)

[Confirmation](#)

Dangerous goods

[Dangerous goods information](#)

Further information

Information on the packaging

<https://support.industry.siemens.com/cs/ww/en/view/109813875>

Information- and Downloadcenter (Catalogs, Brochures,...)

<http://www.siemens.com/lowvoltage/catalogs>

Industry Mall (Online ordering system)

<https://mall.industry.siemens.com/mall/en/en/Catalog/product?mlfb=3WA9111-1AK54>

Service&Support (Manuals, Certificates, Characteristics, FAQs,...)

<https://support.industry.siemens.com/cs/ww/en/ps/3WA9111-1AK54>

Image database (product images, 2D dimension drawings, 3D models, device circuit diagrams, ...)

http://www.automation.siemens.com/bilddb/cax_en.aspx?mlfb=3WA9111-1AK54

CAX-Online-Generator

<http://www.siemens.com/cax>

Tender specifications

<http://www.siemens.com/specifications>

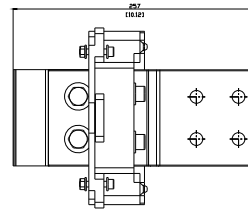
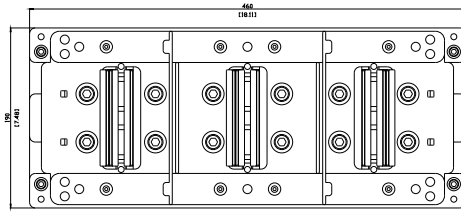

last modified:

4/13/2025 

