

Flashlight element, with integrated LED, clear, 230 V AC, Diameter 70 mm



General technical data	
Product brand name	SIRIUS
Product designation	Repeated-flash light element
Design of the optical signal	blinklight
Type of voltage of the operating voltage	AC
Operating voltage	
• 1 at AC at 50 Hz rated value	230 V
• 1 at AC at 60 Hz rated value	230 V
Relative positive tolerance of the operating voltage	10 %
Relative negative tolerance of the operating voltage	-10 %
Consumed current maximum	35 mA
Service life of LED	100 000 h
Material	PC
Color	clear
Mounting type	Bayonet
Reference code	
• acc. to DIN EN 61346-2	P
• acc. to DIN EN 81346-2	P

Mechanical data

Outer diameter of the signal column element 70 mm

Lamp

Product component Light source	Yes
Type of light source	LED
Flash frequency	1 Hz
Light intensity	1.29 cd
Light intensity	0.83 ... 1.89 cd

Ambient conditions

Ambient temperature during operation	-20 ... +50 °C
Protection class IP	IP65
Height	65.5 mm
Width	70 mm

Certificates/ approvals

General Product Approval



EMC



Declaration of Conformity



[Miscellaneous](#)

other

[Confirmation](#)

Further information

Information- and Downloadcenter (Catalogs, Brochures,...)

www.siemens.com/sirius/catalogs

Industry Mall (Online ordering system)

<https://mall.industry.siemens.com/mall/en/en/Catalog/product?mlfb=8WD4450-5BE>

Cax online generator

<http://support.automation.siemens.com/WW/CAXorder/default.aspx?lang=en&mlfb=8WD4450-5BE>

Service&Support (Manuals, Certificates, Characteristics, FAQs,...)

<https://support.industry.siemens.com/cs/ww/en/ps/8WD4450-5BE>

Image database (product images, 2D dimension drawings, 3D models, device circuit diagrams, EPLAN macros, ...)

http://www.automation.siemens.com/bilddb/cax_de.aspx?mlfb=8WD4450-5BE&lang=en

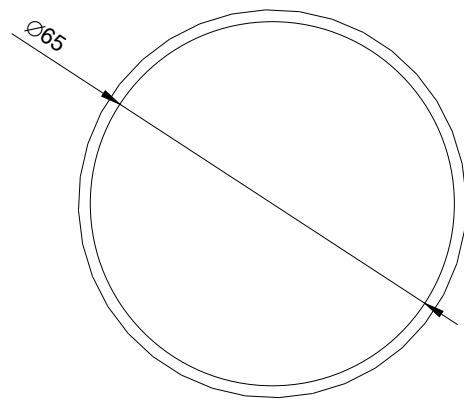
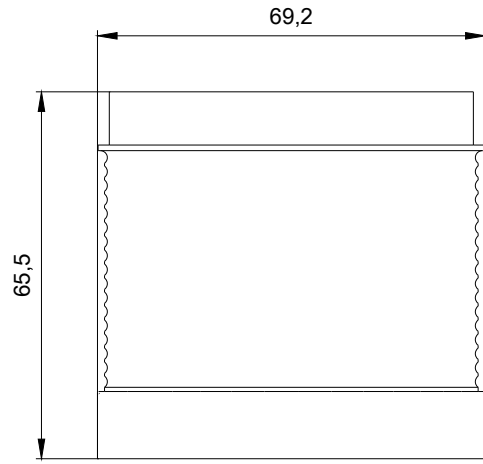

last modified:

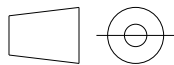

WS 4444;
W6.8333; 8WD44..._ALL
10/07/2019