

THIS COPY IS PROVIDED ON A RESTRICTED BASIS AND IS NOT TO BE USED IN ANY WAY DETRIMENTAL TO THE INTERESTS OF PANDUIT CORP.

NOTES:

1. DIMENSION IN PARENTHESIS ARE MILLIMETERS
2. WIRE RANGE: #6 AWG SOLID TO 1/0 STRANDED (16 TO 50 mm)
3. TIGHTENING TORQUE: #6 - #4 AWG = 165 lbf-in
#3 - #1 AWG = 275 lbf-in
1/0 AWG = 385 lbf-in
4. INSTALLATION TOOL: 1-1/2" HEX WRENCH FOR HEX NUT
3/4" HEX WRENCH FOR BODY
5. MATERIAL: HIGH CONDUCTIVITY BRONZE ALLOY
6. CLAMP IS UL LISTED AND CSA CERTIFIED AND SUITABLE FOR USE IN DIRECT BURIAL APPLICATIONS. UL LISTED AND CSA CERTIFIED FOR APPLICATIONS UP TO 600V. TEMP RATING 90°C MAX.

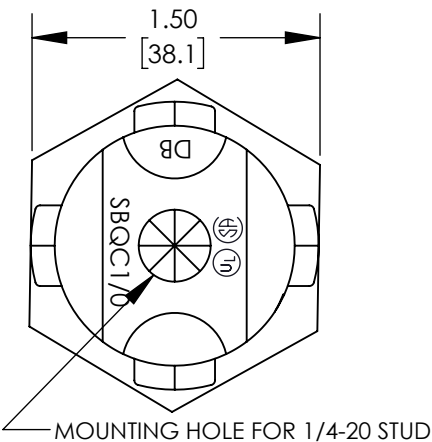
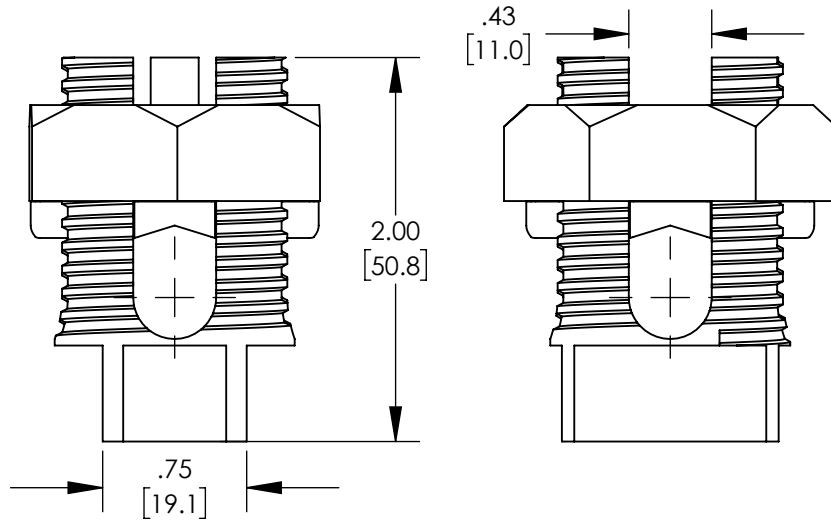
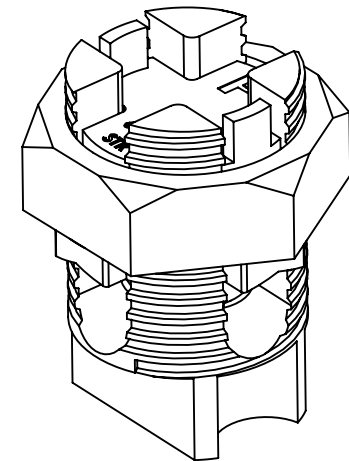

REV	DATE	BY	CHK	APR	DESCRIPTION	ECN
01	7/19	JHNU	JHNU	RGB	REVISED NOTE 6: ADDED 600V & 90°C MAX.	10N016AC-NC
00	4/10	JHNU	JHNU	RGB	DRAWING RELEASED	10N016AC-NC

TITLE SPLIT BOLT QUAD CLAMP (SBQC1/0-X) CUSTOMER DRAWING			
ITEM REVISION NAME 10N016AC-NC/01		PANDUIT	
DATASET FILE NAME 10N016AC-NC_01.SLDDRW			
UNLESS OTHERWISE SPECIFIED, DIMENSIONAL TOLERANCES ARE: IN [mm] .X ± .XXX ± .XX ± ANGLES ±			MATERIAL SEE NOTES
DRAWN BY JHNU			DRAWING NUMBER 10N016AC-NC
DATE 4/10	CHK RGB	SCALE N/A	SHEET 1 OF 1
THIRD ANGLE PROJECTION			SIZE A