



Figure similar

AS-i SlimLine module Phased-out product !!! For further information, please contact our sales department S22.5 digital 4 DI, IP20 4 x inputs for 3-wire sensor spring-type terminals Overall width 22.5 mm

General technical data		
design of the product		SlimLine S22.5 - I/O modules for operation in the control cabinet, IP20
design of the slave type		standard slave
Type		4 inputs
I/O configuration		0
ID/ID2 code		0/F
protocol is supported AS-Interface protocol		Yes
AS interface total current input max	mA	270
operating voltage according to AS-Interface specification	V	26.5 ... 31.6
Addressing		front addressing socket
type of electrical connection of the inputs and outputs		spring-loaded terminals
reference code according to DIN 40719 extended according to IEC 204-2 according to IEC 750		A
reference code according to EN 61346-2		K
note		An external additional supply (AUX POWER) of 20 to 30 V DC is required for the supply of the output circuits. The additional supply must comply with VDE 0106 (PELV), protection class III.
Note 1		detachment tool for spring-loaded terminal connection: See Accessories
Sensor supply		
type of voltage supply for sensor supply		using AS-Interface
input voltage	V	20 ... 30
property of the sensor supply short-circuit and overload resistant		Yes
ampacity of the sensor supply for all inputs		
• at ambient temperature 40 °C	mA	200
Inputs		
number of digital inputs		4
type of connection technology		2- and 3-wire technology
Input circuit		PNP transistor
type of voltage of the input voltages		DC
Inputs switching level High min	V	10
input current at digital input		
• for signal <1> minimum	mA	5
• with signal <0> maximum	mA	1.5
Inputs sensor supply using AS-Interface		short-circuit and overload resistant
Outputs		
number of digital outputs		0
output voltage at DC at 24 V	V	22 ... 24
Status display		

<ul style="list-style-type: none"> <li>• display of I/Os</li> <li>• AS-Interface</li> <li>• FAULT</li> </ul>		yellow LED green LED red LED
<b>Assignment of data bits</b> <ul style="list-style-type: none"> <li>• D0</li> <li>• D1</li> <li>• D2</li> <li>• D3</li> </ul>		IN1 IN2 IN3 IN4

<b>Ambient conditions</b>		
<b>ambient temperature</b> <ul style="list-style-type: none"> <li>• during operation</li> <li>• during storage</li> </ul>	°C °C	-25 ... +70 -40 ... +85
<b>protection class IP</b>		IP20

<b>Mechanical data</b>		
<b>width</b>	mm	22.5
<b>height</b>	mm	103
<b>depth</b>	mm	86
<b>fastening method</b>		35 mm standard rail mounting or wall mounting using push-in lugs
<b>Conductor cross-section</b> <ul style="list-style-type: none"> <li>• solid</li> <li>• finely stranded               <ul style="list-style-type: none"> <li>— with end sleeve</li> <li>— without end sleeve</li> </ul> </li> <li>• AWG solid or stranded</li> </ul>		2 x (0.25 - 1.5) mm <sup>2</sup> 2 x (0.25 - 1) mm <sup>2</sup> 2 x (0.25 - 1.5) mm <sup>2</sup> AWG 2 x (24 - 16) mm <sup>2</sup>

<b>Certificates/ approvals</b>	
General Product Approval	EMV



[Confirmation](#)



EMV	Marine / Shipping	other	Environment
<a href="#">KC</a>	 DNV	 PRS	<a href="#">Confirmation</a> <a href="#">Miscellaneous</a> <a href="#">Environmental Confirmations</a>

### Industrial Communication



### Further information

**Information on the packaging**

<https://support.industry.siemens.com/cs/ww/en/view/109813875>

**Information- and Downloadcenter (Catalogs, Brochures,...)**

<https://www.siemens.com/ic10>

**Industry Mall (Online ordering system)**

<https://mall.industry.siemens.com/mall/en/en/Catalog/product?mlfb=3RK1200-0CG02-0AA2>

**Cax online generator**

<http://support.automation.siemens.com/WWW/CAXorder/default.aspx?lang=en&mlfb=3RK1200-0CG02-0AA2>

**Service&Support (Manuals, Certificates, Characteristics, FAQs,...)**

<https://support.industry.siemens.com/cs/ww/en/ps/3RK1200-0CG02-0AA2>

**Image database (product images, 2D dimension drawings, 3D models, device circuit diagrams, EPLAN macros, ...)**

[http://www.automation.siemens.com/bilddb/cax\\_de.aspx?mlfb=3RK1200-0CG02-0AA2&lang=en](http://www.automation.siemens.com/bilddb/cax_de.aspx?mlfb=3RK1200-0CG02-0AA2&lang=en)

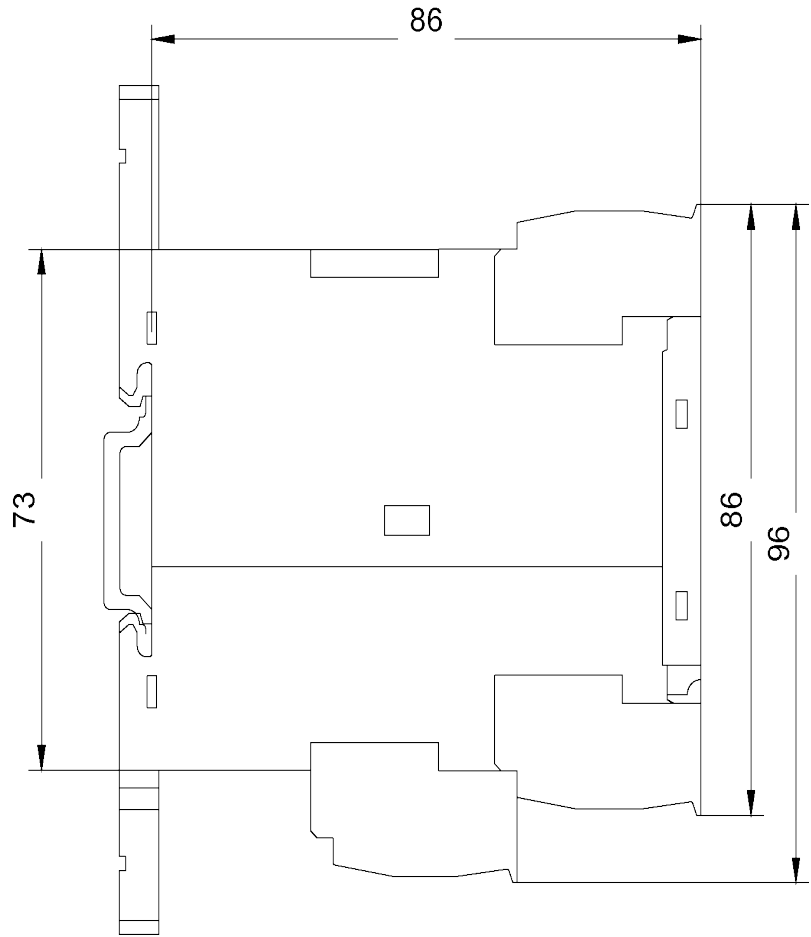
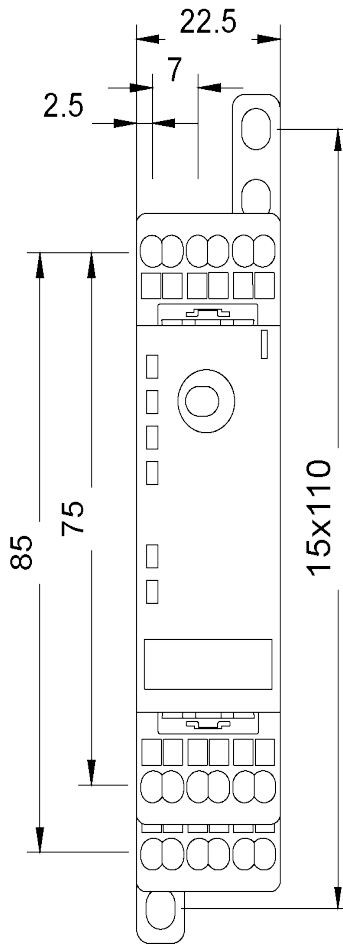

last modified:

3/11/2024 