

CONTACTOR RELAY, 6 NO+2 NC, NON-DETACHABLE CONTACT BLOCK, 110 V AC 50 HZ/120 V 60 HZ, SCREW CONNECTION, SIZE S00



Figure similar

product brandname	SIRIUS
Product designation	contactor relay
General technical data	
Size of contactor	S00
Product extension	
• Auxiliary switch	No
Insulation voltage	
• with degree of pollution 3 rated value	690 V
Degree of pollution	3
Surge voltage resistance rated value	6 kV
Protection class IP	
• on the front	IP20
Mechanical service life (switching cycles)	
• of contactor typical	10 000 000
Equipment marking	
• acc. to DIN EN 61346-2	K
• acc. to DIN EN 81346-2	K

Ambient conditions

Ambient temperature

- | | |
|--------------------|----------------|
| • during operation | -25 ... +60 °C |
| • during storage | -55 ... +80 °C |
| • during transport | -55 ... +80 °C |

Control circuit/ Control

Type of voltage of the control supply voltage

AC

Control supply voltage at AC

- | | |
|------------------------|-------|
| • at 50 Hz rated value | 110 V |
| • at 60 Hz rated value | 120 V |

Operating range factor control supply voltage rated value of magnet coil at AC

- | | |
|------------|--------------|
| • at 50 Hz | 0.8 ... 1.1 |
| • at 60 Hz | 0.85 ... 1.1 |

Apparent pick-up power of magnet coil at AC

27 V·A

Inductive power factor with closing power of the coil

0.8

Apparent holding power of magnet coil at AC

4.6 V·A

Inductive power factor with the holding power of the coil

0.27

Closing power of magnet coil at DC

3.2 W

Holding power of magnet coil at DC

3.2 W

Auxiliary circuit

Number of NC contacts

- | | |
|-------------------------------|---|
| • for auxiliary contacts | 2 |
| — instantaneous contact | 2 |
| — delayed switching | 0 |
| — lagging switching | 0 |
| — make-before-break switching | 0 |

Number of NO contacts

- | | |
|-------------------------------|---|
| • for auxiliary contacts | 6 |
| — instantaneous contact | 6 |
| — delayed switching | 0 |
| — leading contact | 0 |
| — make-before-break switching | 0 |

Number of CO contacts

- | | |
|---|---|
| • for auxiliary contacts | 0 |
| • of auxiliary contacts instantaneous contact | 0 |

Identification number and letter for switching elements

62 E

Operating current at AC-12 maximum

10 A

Operating current at AC-15

- | | |
|------------------------|-----|
| • at 230 V rated value | 6 A |
|------------------------|-----|

<ul style="list-style-type: none"> • at 400 V rated value • at 500 V rated value • at 690 V rated value 	3 A 2 A 1 A
Operating current at 1 current path at DC-12 <ul style="list-style-type: none"> • at 24 V rated value • at 110 V rated value • at 220 V rated value 	10 A 3 A 1 A
Operating current at 1 current path at DC-13 <ul style="list-style-type: none"> • at 24 V rated value • at 110 V rated value • at 220 V rated value 	10 A 1 A 0.27 A
Contact reliability of auxiliary contacts	1 faulty switching per 100 million (17 V, 1 mA)

Short-circuit protection

Design of the fuse link <ul style="list-style-type: none"> • for short-circuit protection of the auxiliary switch required 	fuse gL/gG: 10 A
--	------------------

Installation/ mounting/ dimensions

Mounting position	+/-180° rotation possible on vertical mounting surface; can be tilted forward and backward by +/- 22.5° on vertical mounting surface
Mounting type	screw and snap-on mounting
Height	57.5 mm
Width	45 mm
Depth	111 mm
Required spacing <ul style="list-style-type: none"> • with side-by-side mounting <ul style="list-style-type: none"> — at the side 	0 mm

Connections/Terminals

Type of electrical connection <ul style="list-style-type: none"> • for auxiliary and control current circuit 	screw-type terminals
Type of connectable conductor cross-sections <ul style="list-style-type: none"> • for auxiliary contacts <ul style="list-style-type: none"> — solid — finely stranded with core end processing • at AWG conductors for auxiliary contacts 	2x (0.5 ... 1.5 mm ²), 2x (0.75 ... 2.5 mm ²), 2x 4 mm ² 2x (0.5 ... 1.5 mm ²), 2x (0.75 ... 2.5 mm ²) 2x (20 ... 16), 2x (18 ... 14), 1x 12

Safety related data



B10 value <ul style="list-style-type: none"> • with high demand rate acc. to SN 31920 	1 000 000; With 0.3 x I _e
Proportion of dangerous failures <ul style="list-style-type: none"> • with low demand rate acc. to SN 31920 • with high demand rate acc. to SN 31920 	40 % 75 %

T1 value for proof test interval or service life acc. to IEC 61508

20 y

Certificates/approvals

General Product Approval	Functional Safety/Safety of Machinery	Declaration of Conformity
 CCC	 UL	 EG-Konf.
 CSA		Type Examination

Test Certificates	Shipping Approval	other
Special Test Certificate	 ABS	Miscellaneous
Type Test Certificates/Test Report	 RMRS	Environmental Confirmations

other
Confirmation

Further information

Information- and Downloadcenter (Catalogs, Brochures,...)

<http://www.siemens.com/industrial-controls/catalogs>

Industry Mall (Online ordering system)

<https://mall.industry.siemens.com/mall/en/en/Catalog/product?mlfb=3RH1262-1AK60>

Cax online generator

<http://support.automation.siemens.com/WW/CAXorder/default.aspx?lang=en&mlfb=3RH1262-1AK60>

Service&Support (Manuals, Certificates, Characteristics, FAQs,...)

<https://support.industry.siemens.com/cs/ww/en/ps/3RH1262-1AK60>

Image database (product images, 2D dimension drawings, 3D models, device circuit diagrams, EPLAN macros, ...)

http://www.automation.siemens.com/bilddb/cax_de.aspx?mlfb=3RH1262-1AK60&lang=en

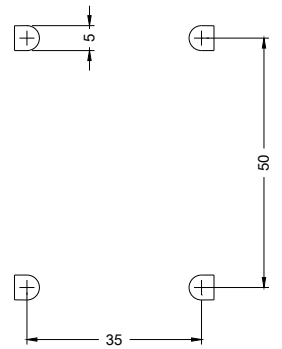
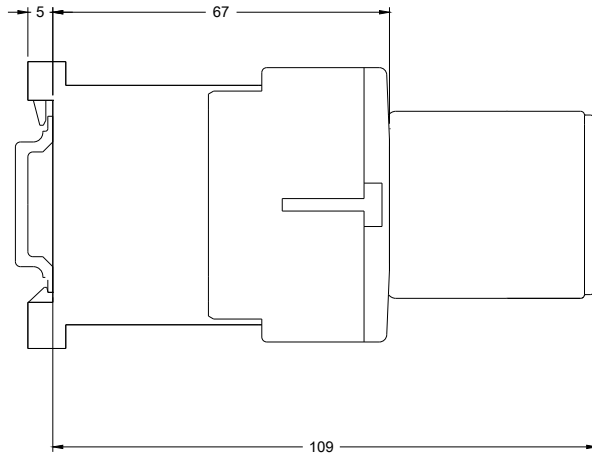
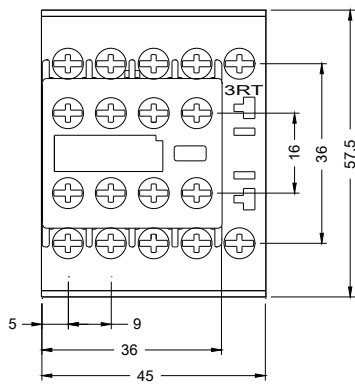

last modified:

06/20/2017