



Vertical Connect. (top/bottom), for circuit breakers fixed mounted, Frame Size 3, for 3WA2 breaking capacity class H / E, In = 4000A, for 3WA3 breaking capacity class M / H / E, In = 4000A, 1 piece

Approvals Certificates

General Product Approval	EMV	Test Certificates	other
 EG-Konf.		 RCM	Type Test Certificates/Test Report

[Miscellaneous](#)

[Confirmation](#)

Further information

Information on the packaging

<https://support.industry.siemens.com/cs/ww/en/view/109813875>

Information- and Downloadcenter (Catalogs, Brochures,...)

<http://www.siemens.com/lowvoltage/catalogs>

Industry Mall (Online ordering system)

<https://mall.industry.siemens.com/mall/en/en/Catalog/product?mlfb=3WA9111-1AJ31>

Service&Support (Manuals, Certificates, Characteristics, FAQs,...)

<https://support.industry.siemens.com/cs/ww/en/ps/3WA9111-1AJ31>

Image database (product images, 2D dimension drawings, 3D models, device circuit diagrams, ...)

http://www.automation.siemens.com/bilddb/cax_en.aspx?mlfb=3WA9111-1AJ31

CAX-Online-Generator

<http://www.siemens.com/cax>

Tender specifications

<http://www.siemens.com/specifications>

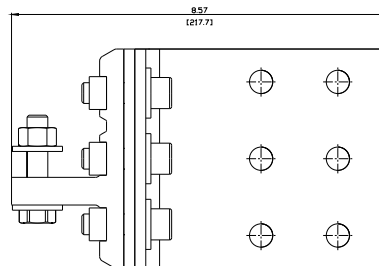
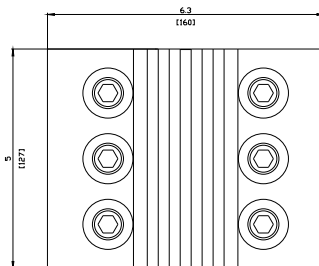

last modified:

4/13/2025 