



SOLID-STATE TIME-DELAY AUXILIARY SWITCH,
OFF-DELAY WITHOUT AUXILIARY VOLTAGE RELAY
1 NC + 1 NO 24...240V AC/DC TIME RANGE
0.05...100S FOR SNAPPING ONTO THE FRONT; FOR
3RT2 S00-S2 CONTACTORS SCREW TERMINALS
INTEGRATED VARISTOR FOR DAMPING
CONTACTOR COILS

General technical data:

product brand name		SIRIUS
Size of contactor can be combined company-specific		S00, S0, S2
Protection class IP of the terminal		IP20
Degree of pollution		3
Installation altitude at height above sea level maximum	m	2 000
Ambient temperature		
• during storage	°C	-40 ... +85
• during operation	°C	-25 ... +60
• during transport	°C	-40 ... +85
Conducted interference due to burst acc. to IEC 61000-4-4		2 kV network connection / 1 kV control connection
Conducted interference due to conductor-earth surge acc. to IEC 61000-4-5		2 kV
Conducted interference due to conductor-conductor surge acc. to IEC 61000-4-5		1 kV
Electrostatic discharge acc. to IEC 61000-4-2		8 kV
Field-bound parasitic coupling acc. to IEC 61000-4-3		10 V/m
Surge voltage resistance Rated value	kV	4
Equipment marking acc. to DIN 40719 extended according to IEC 204-2 acc. to IEC 750		K
Equipment marking acc. to DIN EN 61346-2		K
Adjustable time	s	0.05 ... 100
Switching function		
• ON-delay		No

<ul style="list-style-type: none"> • passing make contact • fixed clock cycle beginning with pulse • fixed clock cycle beginning with interval • OFF delay • variably clocked start with impulse • variably clocked start with interval 		No
		No
		No
		Yes
		No
		No
Switching function		
<ul style="list-style-type: none"> • with control signal <ul style="list-style-type: none"> — additive ON delay — passing break contact — OFF delay — pulse-shaping 		No
		No
		No
		No
Product component semi-conductor output		No
Product expansion		
<ul style="list-style-type: none"> • optional remote control • required remote control 		No
		No
Product function		
<ul style="list-style-type: none"> • star-delta circuit • at the relay outputs Switchover delayed/without delay 		No
		No

Control circuit/ Control:

Design of the surge suppressor		with varistor
Type of voltage of the control supply voltage		AC/DC
Control supply voltage frequency 1	Hz	50 ... 60
Control supply voltage 1		
<ul style="list-style-type: none"> • for DC • with AC <ul style="list-style-type: none"> — at 50 Hz — at 60 Hz 	V	24 ... 240
	V	24 ... 240
	V	24 ... 240

Auxiliary circuit:

Operating current of the auxiliary contacts		
<ul style="list-style-type: none"> • at AC-15 at 250 V • at DC-13 <ul style="list-style-type: none"> — at 24 V — at 125 V — at 250 V 	A	3
	A	1
	A	0.2
	A	0.1

Installation/ mounting/ dimensions:

mounting position		any (like contactor)
Mounting type		clip-on
Width	mm	45
Height	mm	38

Depth	mm	74
Required spacing with side-by-side mounting		
• upwards	mm	0
• downwards	mm	0
• forwards	mm	0
• Backwards	mm	0
• at the side	mm	0
Required spacing for grounded parts		
• upwards	mm	0
• downwards	mm	0
• forwards	mm	0
• Backwards	mm	0
• at the side	mm	0
Required spacing for live parts		
• upwards	mm	0
• downwards	mm	0
• forwards	mm	0
• Backwards	mm	0
• at the side	mm	0

Connections/ Terminals:

Type of electrical connection for auxiliary and control current circuit		screw-type terminals
Product function removable terminal for auxiliary and control circuit		Yes

Certificates/ approvals:

General Product Approval



CCC



CSA



UL



Test Certificates

[Type Test
Certificates/Test
Report](#)

[Special Test
Certificate](#)

Shipping Approval



ABS



BUREAU
VERITAS



DNV



GL



LRS



RMRS

other

[Environmental
Confirmations](#)

[Declaration of
Conformity](#)

[other](#)

UL/CSA ratings:

Contact rating of the auxiliary contacts acc. to UL

B300 / R300

Further information

Information- and Downloadcenter (Catalogs, Brochures,...)

<http://www.siemens.com/industrial-controls/catalogs>

Industry Mall (Online ordering system)

<http://www.siemens.com/industrymall>

Cax online generator

<http://support.automation.siemens.com/WW/CAXorder/default.aspx?lang=en&mlfb=3RA28151FW10>

Service&Support (Manuals, Certificates, Characteristics, FAQs,...)

<https://support.industry.siemens.com/cs/ww/en/ps/3RA28151FW10>

Image database (product images, 2D dimension drawings, 3D models, device circuit diagrams, EPLAN macros, ...)

http://www.automation.siemens.com/bilddb/cax_de.aspx?mlfb=3RA28151FW10&lang=en

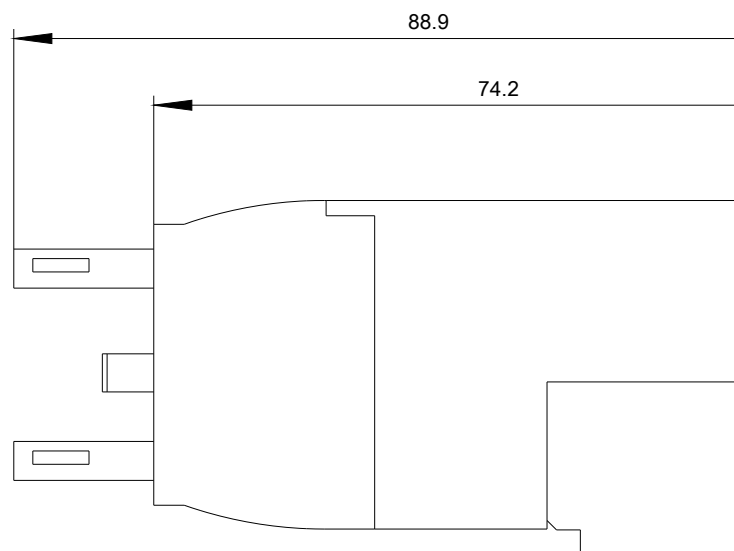
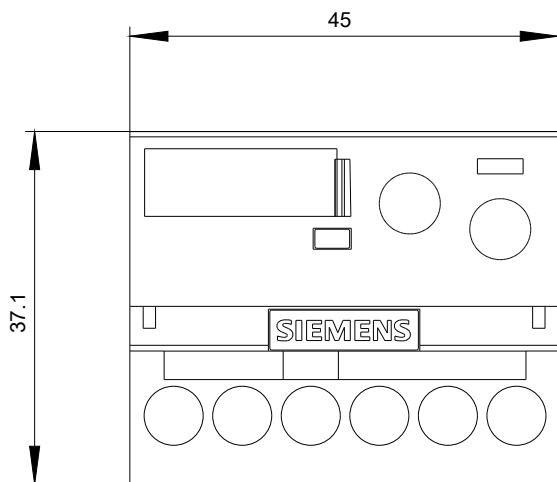

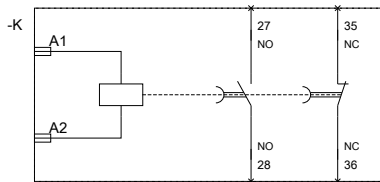

last modified:

24.04.2015