

Contactor, Size 14, 3-pole, AC-3, 335kW, 400/380 V (690 V)
 Auxiliary switch 33 (3 NO+3 NC) with reversing contactor 3TC4417-4A and series resistor DC economy circuit 24 V DC

Product designation	Vacuum contactor
Product type designation	3TF6

General technical data

Size of contactor	14
Protection class IP	
<ul style="list-style-type: none"> on the front 	IP00
Reference code acc. to DIN EN 81346-2	Q

Main circuit

Number of poles for main current circuit	3
Number of NO contacts for main contacts	3
Number of NC contacts for main contacts	0
Operating current	
<ul style="list-style-type: none"> at AC-3 <ul style="list-style-type: none"> at 400 V rated value at AC-4 at 400 V rated value 	630 A 300 A
Operating power	
<ul style="list-style-type: none"> at AC-1 <ul style="list-style-type: none"> at 400 V rated value at AC-3 <ul style="list-style-type: none"> at 400 V rated value at AC-4 at 400 V rated value 	415 kW 335 kW 168 000 W

Control circuit/ Control

Type of voltage of the control supply voltage	DC
Control supply voltage at DC	
<ul style="list-style-type: none"> rated value 	24 V
Control version of the switch operating mechanism	conventional

Auxiliary circuit

Number of NC contacts for auxiliary contacts	
<ul style="list-style-type: none"> instantaneous contact 	3
Number of NO contacts for auxiliary contacts	
<ul style="list-style-type: none"> instantaneous contact 	3

Installation/ mounting/ dimensions

Mounting type	screw fixing
----------------------	--------------

• Side-by-side mounting	Yes
Height	232 mm
Width	230 mm
Depth	237 mm

Connections/ Terminals

Type of electrical connection	
• for main current circuit	screw-type terminals
• for auxiliary and control current circuit	screw-type terminals

Certificates/ approvals

General Product Approval	Functional Safety/Safety of Machinery
---------------------------------	--



[Type Examination Certificate](#)

Declaration of Conformity	Test Certificates	Marine / Shipping
----------------------------------	--------------------------	--------------------------



[Miscellaneous](#)

[Type Test Certificates/Test Report](#)

[Special Test Certificate](#)

[Miscellaneous](#)



Marine / Shipping	other
--------------------------	--------------



[Environmental Confirmations](#)

[Confirmation](#)

Further information

Information- and Downloadcenter (Catalogs, Brochures,...)

www.siemens.com/sirius/catalogs

Industry Mall (Online ordering system)

<https://mall.industry.siemens.com/mall/en/en/Catalog/product?mlfb=3TF6833-1DB4>

Cax online generator

<http://support.automation.siemens.com/WW/CAXorder/default.aspx?lang=en&mlfb=3TF6833-1DB4>

Service&Support (Manuals, Certificates, Characteristics, FAQs,...)

<https://support.industry.siemens.com/cs/ww/en/ps/3TF6833-1DB4>

Image database (product images, 2D dimension drawings, 3D models, device circuit diagrams, EPLAN macros, ...)

http://www.automation.siemens.com/bilddb/cax_de.aspx?mlfb=3TF6833-1DB4&lang=en

Characteristic: Tripping characteristics, I²t, Let-through current

<https://support.industry.siemens.com/cs/ww/en/ps/3TF6833-1DB4/char>

Further characteristics (e.g. electrical endurance, switching frequency)

<http://www.automation.siemens.com/bilddb/index.aspx?view=Search&mlfb=3TF6833-1DB4&objecttype=14&gridview=view1>

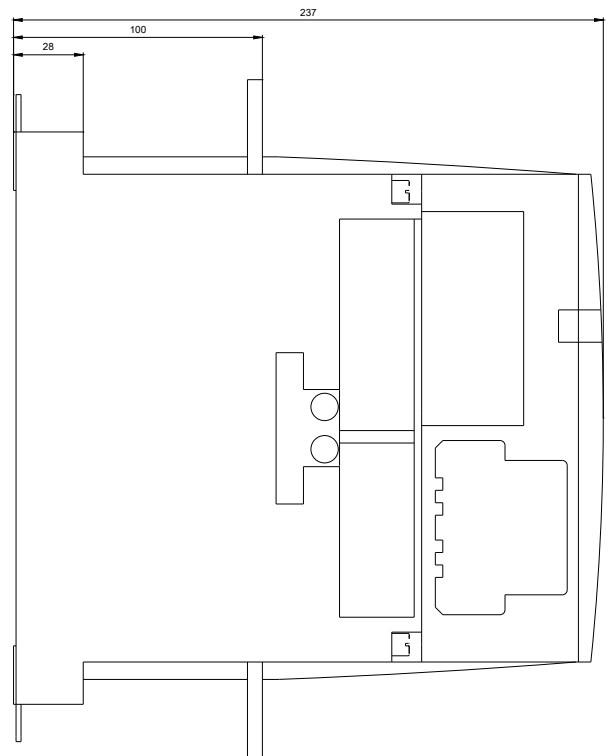
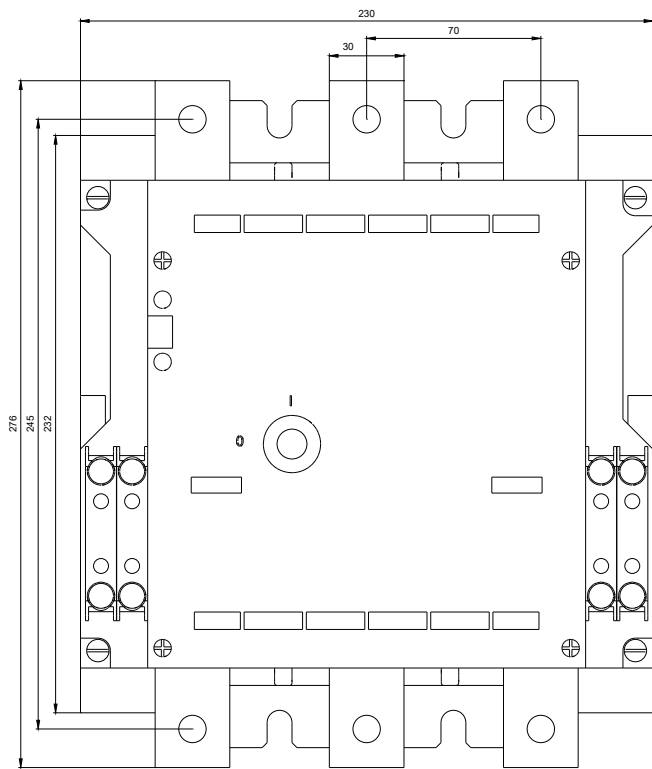

last modified:

08/12/2019