



circuit breaker 3VA2 IEC frame 160 breaking capacity class M Icu=55kA @ 415V 4-pole, line protection ETU330, LIG, In=160A overload protection Ir=63A...160A short-circuit protection Ii=1.5...10 x In N conductor protection adjustable (OFF, 50%, 100%) ground-fault protection Ig=0.2...1 x In= tg=0.1/0.3s clamp connection

| Model  |   |
|--|---|
| product brand name   | SENTRON                                     |
| product designation  | Molded case circuit breaker                 |
| Product version  | Line protection                             |
| design of the overcurrent release  | ETU330                                      |
| protection function of the overcurrent release   | LIG   |
| number of poles  | 4   |
| General technical data   |   |
| Tension assignée d'isolement Ui  | 800 V                                       |
| power loss [W] / maximum   | 25.5 W                                      |
| Active power loss / for rated value of the current / at AC / in hot operating state / per pole | 8.5 W                                       |
| mechanical service life (switching cycles) / typical   | 20 000                                      |
| Electrical endurance (switching cycles) / at AC-1 / at 380/415 V 50/60 Hz                      | 12 000                                      |
| Electrical endurance (switching cycles) / at AC-1 / at 690 V 50/60 Hz                          | 8 000                                       |
| Neutral conductors / upgradeable/retrofitable  | No  |
| ground-fault monitoring version  | Summation current formation L + N conductor |
| product function   |   |
| • communication function   | No  |
| • other measurement function   | No  |
| net weight   | 3.13 kg                                     |
| Current  |   |
| operational current  |   |
| • at 40 °C   | 160 A                                       |
| • at 45 °C   | 160 A                                       |
| • at 50 °C   | 160 A                                       |
| • at 55 °C   | 160 A                                       |
| • at 60 °C   | 160 A                                       |
| • at 65 °C   | 160 A                                       |
| • at 70 °C   | 160 A                                       |
| Switching capacity according to IEC 60947  |   |
| switching capacity class of the circuit breaker  | M   |
| breaking capacity maximum short-circuit current (Icu)  |   |
| • at 240 V   | 85 kA                                       |
| • at 415 V   | 55 kA                                       |
| • at 440 V   | 55 kA                                       |

|  |   |
|--|---|
| <ul style="list-style-type: none"> <li>• at 500 V</li> <li>• at 690 V</li> </ul>   | 36 kA<br>2.5 kA                               |
| breaking capacity operating short-circuit current (Ics) <ul style="list-style-type: none"> <li>• at 240 V</li> <li>• at 415 V</li> <li>• at 440 V</li> <li>• at 500 V</li> <li>• at 690 V</li> </ul>             | 85 kA<br>55 kA<br>55 kA<br>36 kA<br>2.5 kA    |
| short-circuit current making capacity (Icm) <ul style="list-style-type: none"> <li>• at 240 V</li> <li>• at 415 V</li> <li>• at 440 V</li> <li>• at 500 V</li> <li>• at 690 V</li> </ul>                         | 187 kA<br>121 kA<br>121 kA<br>76 kA<br>3.8 kA |
| <b>Adjustable parameters</b>   |   |
| Adjustable response value current / I <sub>g</sub> min.  | 63 A  |
| Adjustable response value current / I <sub>g</sub> min.  | 160 A   |
| Adjustable response value current / I <sub>g</sub> min.  | 0.5   |
| Adjustable response value current / I <sub>g</sub> min.  | 17  |
| Adjustable response value current / I <sub>i</sub> min.  | 240 A   |
| Adjustable response value current / I <sub>i</sub> max.  | 1 600 A                                       |
| design of the N-conductor protection   | adjustable OFF; 50%; 100%                     |
| Ground fault protection / tripping switchable / I <sub>2t</sub> =ON/OFF  | Yes   |
| Adjustable response value current / I <sub>g</sub> min.  | 32 A  |
| Adjustable response value current / I <sub>g</sub> max.  | 160 A   |
| Adjustable response value current / t <sub>g</sub> min.  | 0.1 s   |
| Adjustable response value current / I <sub>g</sub> min.  | 0.3 s   |
| Adjustable response value current / for G-tripping / with I <sub>2t</sub> characteristic / min.  | 0 A   |
| Adjustable response value current / for G-tripping / with I <sub>2t</sub> characteristic / max.  | 0 A   |
| <b>Mechanical Design</b>   |   |
| height [in]  | 7.1 in  |
| Height   | 181 mm  |
| width [in]   | 5.5 in  |
| Width  | 140 mm  |
| depth [in]   | 3.4 in  |
| depth  | 86 mm   |
| <b>Connections</b>   |   |
| arrangement of electrical connectors / for main current circuit  | Front terminal                                |
| type of electrical connection / for main current circuit   | double-sided box terminal                     |
| Type of connectable conductor cross-section, round conductor terminal, stranded  | 1 x (6-120 mm <sup>2</sup> )                  |
| <b>Auxiliary circuit</b>   |   |
| number of CO contacts / for auxiliary contacts   | 0   |
| <b>Accessories</b>   |   |
| product extension / optional / motor drive   | Yes   |
| <b>Environmental conditions</b>  |   |
| protection class IP / on the front   | IP40  |
| ambient temperature <ul style="list-style-type: none"> <li>• during operation / minimum</li> <li>• during operation / maximum</li> <li>• during storage / minimum</li> <li>• during storage / maximum</li> </ul> | -25 °C<br>70 °C<br>-40 °C<br>80 °C            |
| <b>Certificates</b>  |   |
| reference code / acc. to IEC 81346-2   | Q   |
| <b>General Product Approval</b>  | <b>EMC</b>                                    |



[Miscellaneous](#)



| Declaration of Conformity | Test Certificates | Shipping Approval |
|---------------------------|-------------------|-------------------|
|---------------------------|-------------------|-------------------|



EG-Konf.

[Special Test Certificate](#)

[Miscellaneous](#)

[Type Test Certificates/Test Report](#)



ABS



LRS

| Shipping Approval | other |
|-------------------|-------|
|-------------------|-------|

[CCS / China Classification Society](#)

[Manufacturer Declaration](#)

[Miscellaneous](#)

#### Further information

Information- and Downloadcenter (Catalogs, Brochures,...)

<http://www.siemens.com/lowvoltage/catalogs>

Industry Mall (Online ordering system)

<https://mall.industry.siemens.com/mall/en/en/Catalog/product?mlfb=3VA2116-5HM46-0AA0>

Service&Support (Manuals, Certificates, Characteristics, FAQs,...)

<https://support.industry.siemens.com/cs/ww/en/ps/3VA2116-5HM46-0AA0>

Image database (product images, 2D dimension drawings, 3D models, device circuit diagrams, ...)

[http://www.automation.siemens.com/bilddb/cax\\_en.aspx?mlfb=3VA2116-5HM46-0AA0](http://www.automation.siemens.com/bilddb/cax_en.aspx?mlfb=3VA2116-5HM46-0AA0)

Tender specifications

<http://www.siemens.com/specifications>

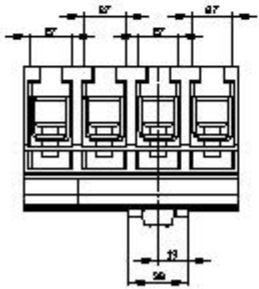
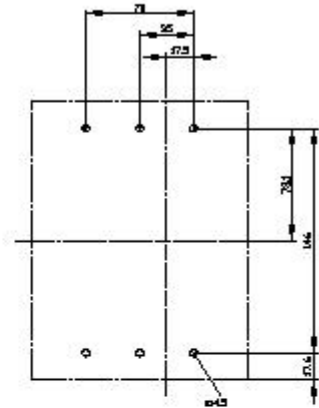
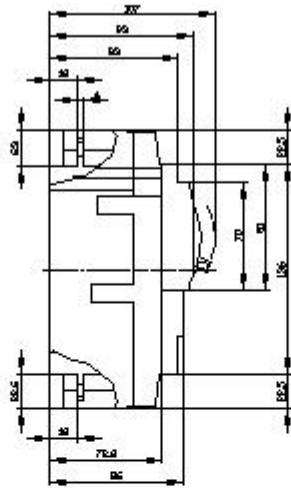
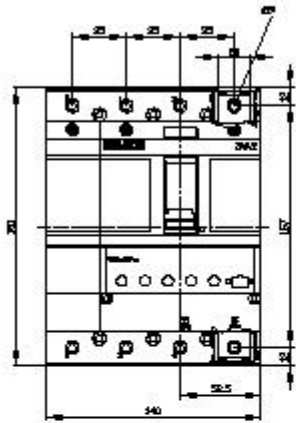

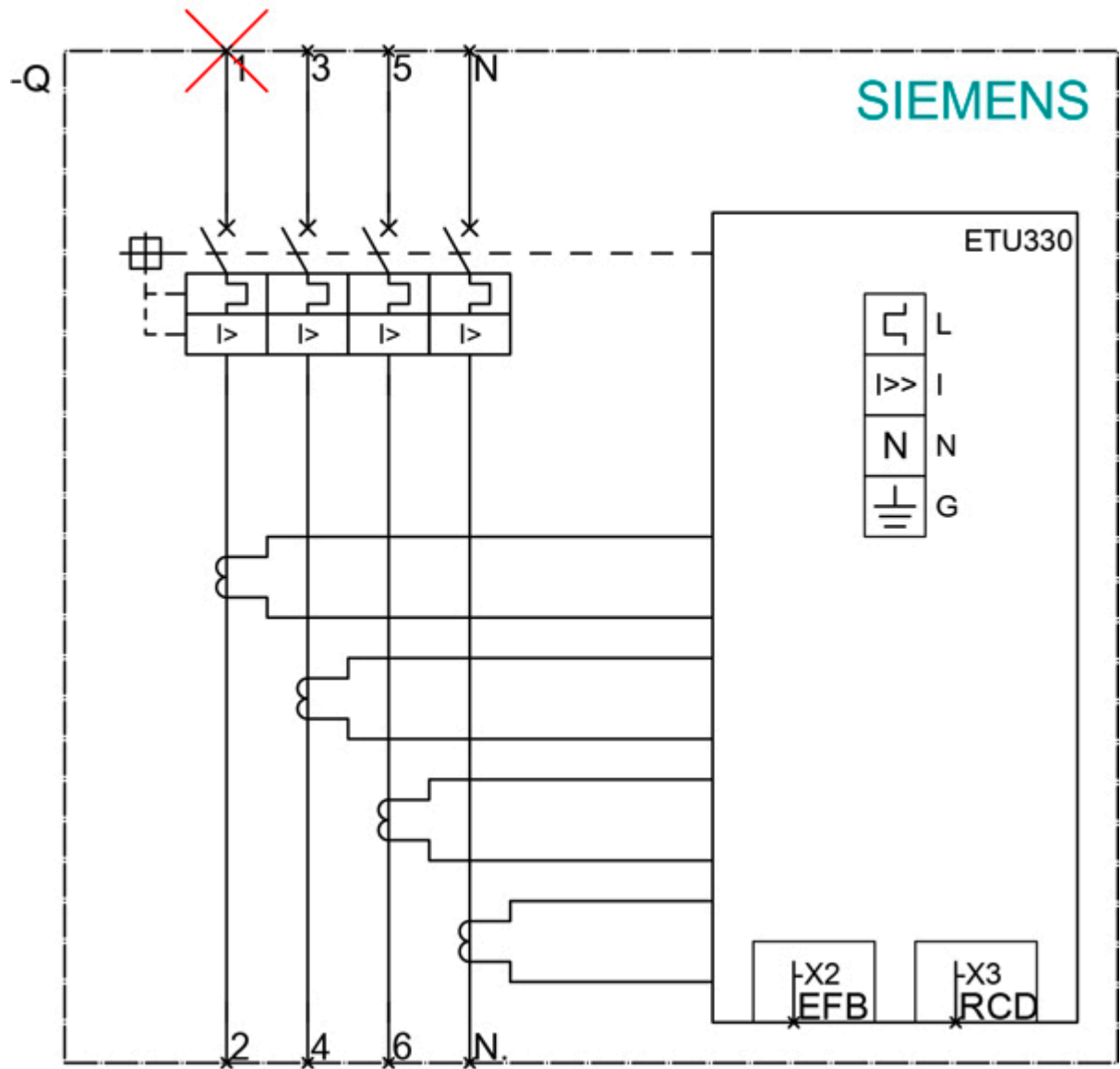

last modified:

12/18/2020 